

MICROFILMED

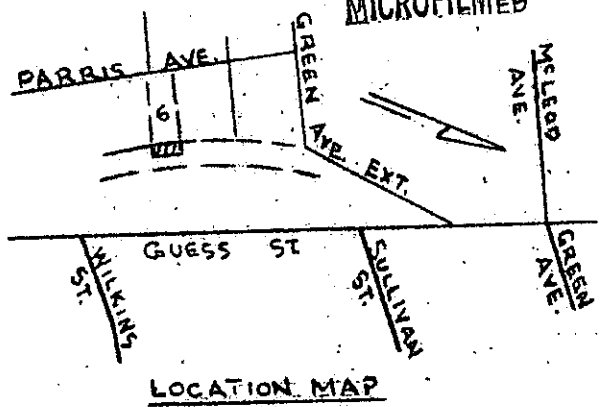

PARRIS AVE.

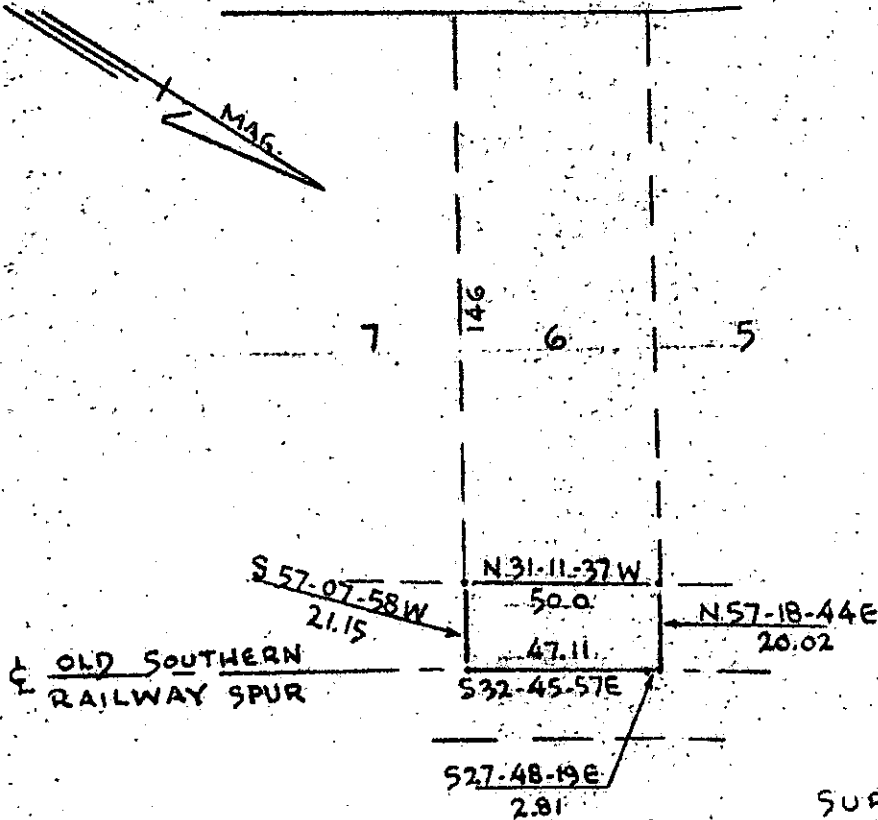

FILED
 GREENVILLE CO. S.C.
 JUN 13 2 01 PM '84
 DONNIE S. FAHKERSLEY
 R.M.C.

SURVEY FOR
 REEVES BROTHERS, INC.
 OLD SOUTHERN RAILWAY RIGHT OF WAY
 REAR OF LOT No. 6

MELROSE LAND CO. 39399
 GREENVILLE CO., S.C.

SCALE 1" = 50'
 50 25 0 50 100
 JAN. 5, 1984

300.8
 31801

Property line information acquired from
 Railway Right of Way taken from
 existing deeds & plats.
 Centerline of Right of Way measured from
 centerline to property corners by
 field survey.

James D. Cain

PLS No. 3320
 PIEDMONT ENGINEERS - ARCHITECTS - PLANNERS
 GREENVILLE, S.C.

10-R-94 JUN 13 1984