

JONES ROAD

N 87-15 E
115.0

FILED
GREENVILLE CO. S. C.
MAY 31 4 29 PM '84
JUNNIE S. TANNER SLEY
R.M.C.

MAG
1979

20' BEAUTIFICATION STRIP

O.I.P.

O.I.P.

- 3 -

- 2 -

- 1 -

N 3-49 W
193.15

N 82-28 W
205.1

Note:
Improvements on this lot are not in a flood hazard area.

Note: 5' Drainage & Utility easement each side all side lot line & 10' inside all rear lot lines.

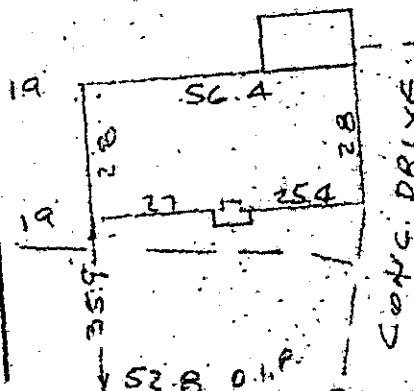

30' BUILDING LINE

BRUSHY CREEK ROAD

37938

MAY 31 1984

BRUSHY CREEK RIDGE
WATER & SEWER IN STRIP
PROPERTY OF

10-R-40

THOMAS J. WOLOSZYN & JANE M. WOLOSZYN
NEAR GREENVILLE, S.C.
SALE 11-40 30 MAY 1984

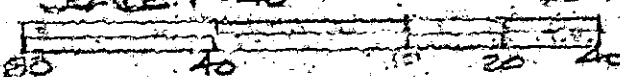

This is to certify that on the 30th day of May, 1984, I surveyed the property shown on this plat being known as lot 2 on plat of BRUSHY CREEK RIDGE and recorded in the RMC Office Greenville County, S.C., in Plat Book " 7 - C " at Page 25 and also known as PROPERTY OF THOMAS J. WOLOSZYN & JANE M. WOLOSZYN and recorded in the RMC Office Greenville County, S. C., in Plat Book " " at Page and that the property lines, walls and buildings are as shown hereon, and that the walls and buildings located on said lot do not encroach or project on adjacent walls or buildings encroach or project on said premises, and no power lines cross this property except as shown hereon.

CAROLINA SURVEYING CO.
112 Manly St.
Greenville, S. C.

R. B. Bruce, RLS # 1952

Recordable Plat

30 MAY 1984 063 3.0001