

[[[CROFILMED

FILED
GREENVILLE CO. S. C.
APR 19 4 03 PM '84
DONNIE S. ANDERSON
R.M.C.

- COMMON AREA -

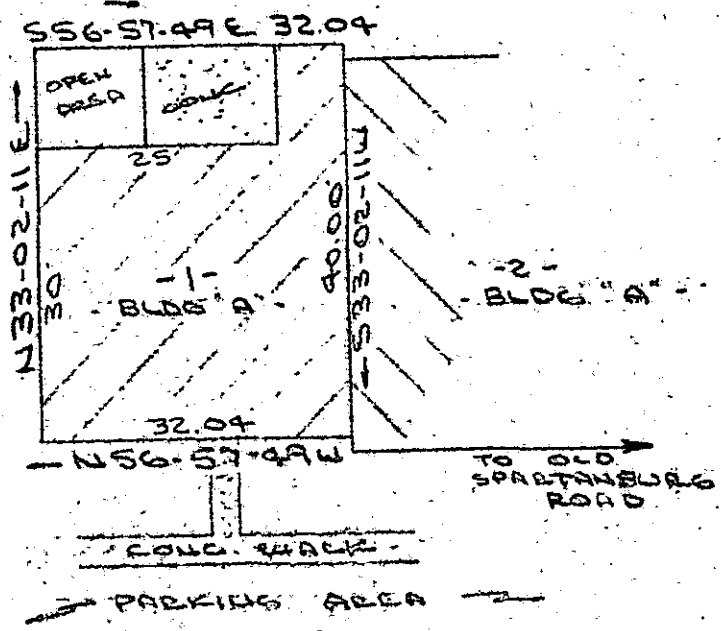

Note:
Improvements on
this lot are not
in a flood hazard
area.

EASTON COURT
WATER & SEWER AVAILABLE

PROPERTY OF
REBECCA S. JOHNSON
NEAR GREENVILLE, S.C.
18 APR 1984

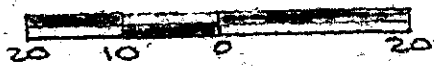

This is to certify that on the 18th day of April, 1984, I surveyed the property shown on this plat, being known as lot 1 Bldg "A" on plat of EASTON TOWNHOUSES and recorded in the RMC Office Greenville County, S. C., in Plat Book "8 - P" at Page 86; and that the property lines, walls and buildings are as shown hereon, and that the walls and buildings located on said lot do not encroach or project on adjacent street or property, and that no adjacent walls or buildings encroach or project on said premises, and no power lines cross this property except as shown hereon.

32746

10-0-20

R. B. Bruce, RLS #1952
SOUTH CAROLINA

Recordable Plat

APR 19 1984

CAROLINA SURVEYING CO.
112 Marly St.
Greenville, S. C.

300-8-21801