

PROPERTY OF  
**FLOYD MICHAEL HALCOMBE**  
 NEAR GREENVILLE, S.C.

SCALE: 1" = 50' 2 APRIL 1984

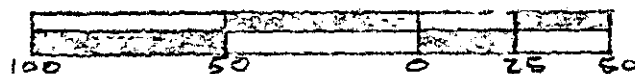

Note:  
 Improvements on this lot are not in a flood hazard area.

This is to certify that on the 2nd day of April, 1984, I surveyed the property shown on this plat, being known as 1.01 acres on plat of FLOYD MICHAEL HALCOMBE and recorded in the RMC Office Greenville County, S. C., in Plat Book at Page ; and that the property lines, walls and buildings are as shown hereon, and that the walls and buildings located on said lot do not encroach or project on adjacent street or property, and that no adjacent walls or buildings encroach or project on said premises, and no power lines cross this property except as shown hereon.

10-L-100

32217

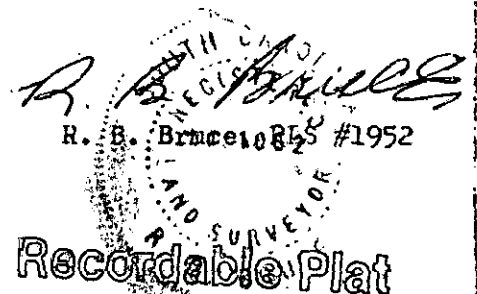

Recordable Plat

FILED  
 GREENVILLE CO. S.C.  
 APR 16 3 24 PM '84  
 DONNIE S. WALKERLEY  
 R.M.C.

CAROLINA SURVEYING CO.  
 112 Manly St.  
 Greenville, S.C. 29616 84 073

3.0000

266/28

617.6-1-10