

FILED  
GREENVILLE CO. S.C.  
MAG.  
OCT 27 4 40 PM '83  
DONNIE S. TAMKERSLEY  
R.M.C.

This is to certify that on October 26, 1983, I surveyed the property shown on this plat, and that the property lines, walls and buildings are as shown hereon; that the building located on said lot does not encroach or project on adjacent streets or property, and that no adjacent walls or buildings encroach or project on said premises, and that no utility lines cross this property except as shown hereon. This property is not located in a designated flood hazard area.

*Fredrick E. Landrith*  
Fredrick E. Landrith  
RLS 9545

OCT 27 1983

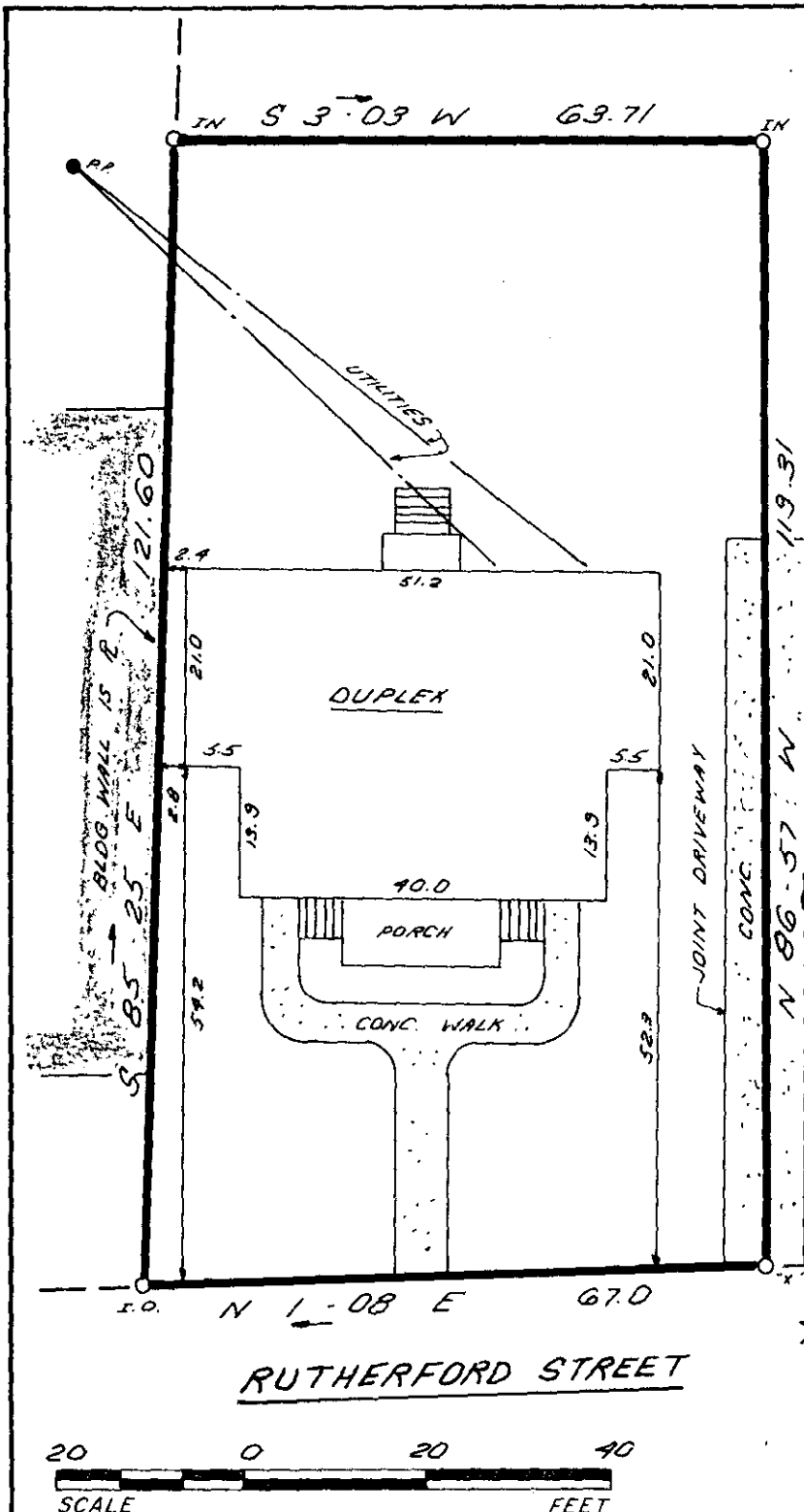

10D-48

STATE OF SOUTH CAROLINA  
GREENVILLE COUNTY

13839

PROPERTY OF  
DEAN WEBB

FREELAND & ASSOCIATES  
Engineers • Land Surveyors

GREENVILLE, S.C.

SURVEY F.E.L.

DRAWN K.E.G.

CHECK M.C.

SCALE 1" = 20'

DATE 10-26-83

DWG. NO. 9924



THE PRINT MACHINE, INC. N-300331