

FILED
GREENVILLE COUNTY S.C.
SEP 28 11 30 AM '83
DONNIE S. R. MENSLEY
R.M.C.

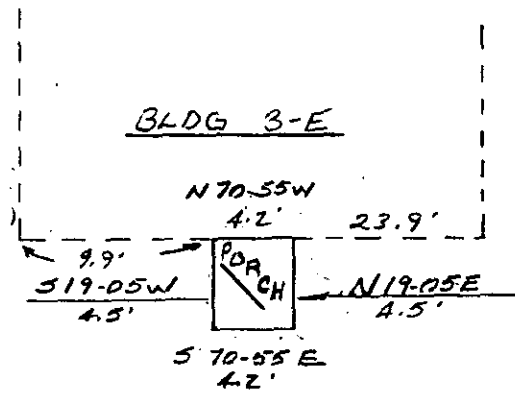
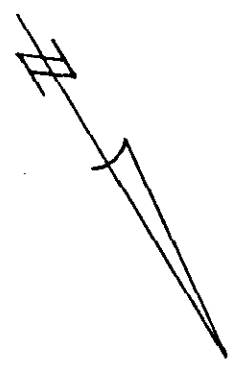

Greenville County
South Carolina

Date: September 14, 1983
Scale: 1" = 10'

PLAT

PROPERTY OF DEREK M. LOADER

This is to certify that on September 14, 1983, the property shown on this plat, being a parcel of land adjacent to Lot 3-E of WOODWIND TOWNHOUSES, PHASE II, as shown on plat recorded in the RMC Office for Greenville County in Plat Book 8-P, page 73, was surveyed under my supervision, and to the best of my knowledge the property lines are as shown thereon.

SEP 28 1983

10355 ✓

Ronald E. Blackmore
Ronald E. Blackmore
R.L.S. #5291



10B-19

300 8 1801