

GREENVILLE CO. S.C.
 SEP 19 11 50 AM '83
 BONNIE S. JAMMERSLEY
 R.M.C.

SEP 19 1983

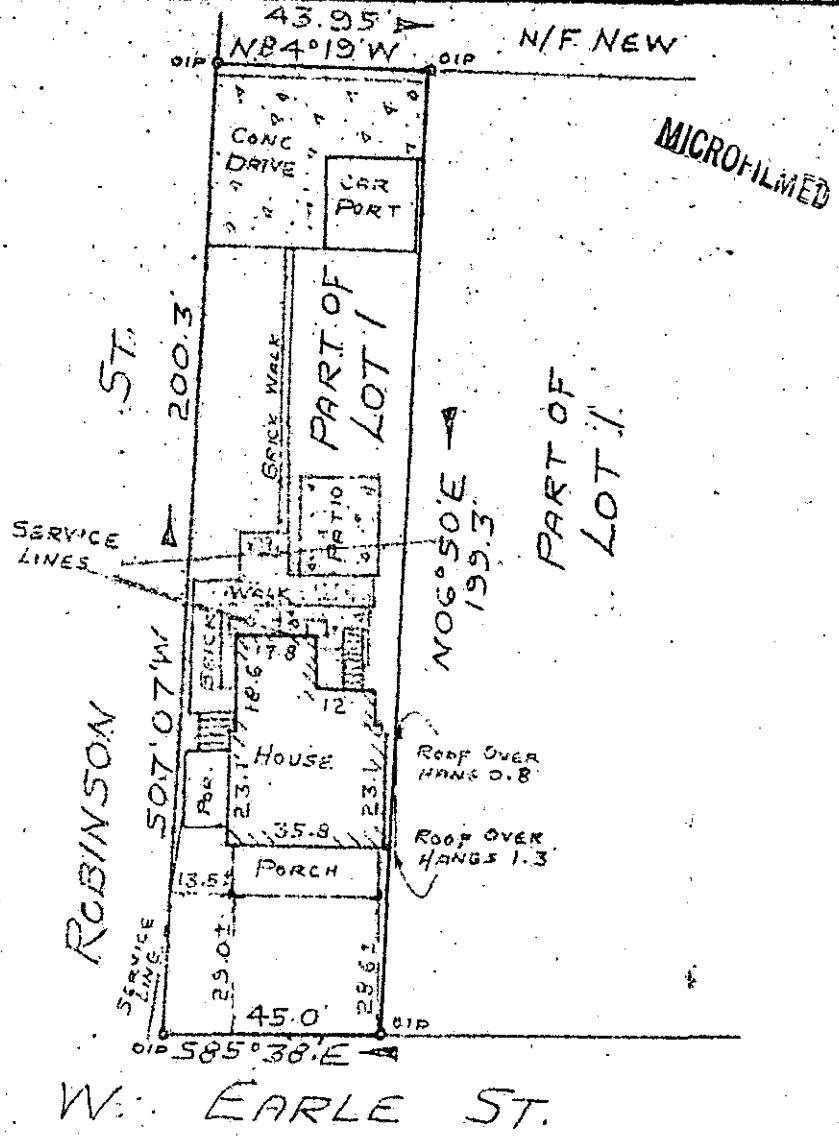
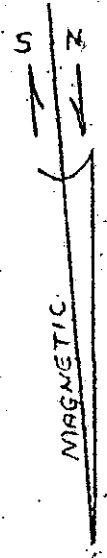

MICROFILMED

PROPERTY OF
 MICHAEL W. GREEN

AND

KIM C. GREEN

GREENVILLE, GREENVILLE COUNTY, S.C.

9291

SEPT 5, 1983

SCALE 1"=40'

9-7-82

This is to certify that on September 5, 1983, I surveyed the property shown on this plat, known as Part of Lot No. 1 of Property of Floride S. Miller, as recorded in the RMC Office for Greenville County, in Plat Book E, Page 99, and that the property lines, walls and buildings are as shown hereon, and that the building located on said lot does not project nor encroach on adjacent streets or property, and that no adjacent walls or buildings project nor encroach on said lot, and that no utility lines cross this lot except as may be shown hereon. The degree of accuracy is 1/10,000.

NOTE: This property is not located within a flood hazard area.

Survey by: Richard D. [Signature]
 Greenville, South Carolina

[Signature]
 R. L. S. No. 1127

