

MICROFILMED

GREENVILLE CO. S. C.
AUG 3 3 42 PM '83
DONNIE S. TAMMERSLEY
R.M.C.

LOT 6

PT. 8

MAG NORTH

S 1 - 26 E 70.02

94.33

S 87 - 15 W

LOT 10

PT. 8

N 87 - 15 E

92.72

23.8

24.6

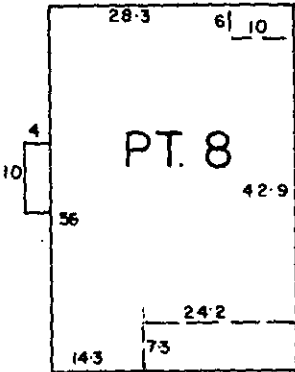

70.0 N 2 - 45 W

140' To WALNUT ST.

WASHINGTON STREET

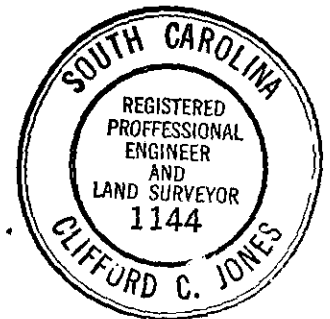

NOTE: THIS LOT DOES NOT LIE IN A FLOOD PLAIN.

4096 ✓

9-Y-32 AUG 3, 1983

PROPERTY OF

WARD STONE SR.

GREENVILLE, S. C.

JULY - 25 - 1983

SCALE 1" = 40'

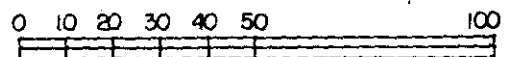

to certify that on the 25 day of JULY 1983, I surveyed the property shown on this plat, being PT. of lot 8 MESSRS CAGLE AND MAULDIN PROP., recorded in Plat Book A 106-107 of the R.M.C. Office for Greenville County, S. C., and that the property lines, walls and buildings are as shown hereon; that the buildings located on said lot do not encroach or project on adjacent streets or property; and that no adjacent buildings or walls encroach or project on said premises, and that no utility lines cross this property.

Engineer No. 1144

JONES ENGINEERING SERVICE 1006 E. PERRY RD.