

MICROFILMED

HAVERHILL STREET

25'

S33-45E 100.05'

575' to FAIRFIELD DRIVE

MAG. TREE PLANT

N

LOT 42

NOTE

DRAINAGE AND UTILITIES EASEMENT 5' EACH SIDE OF SIDE LOT LINES.

REFERENCE

SEE LOT 42 ON "MAP OF GLENDALE" BY C.O. RIDDLE, MAY 1953, RECORDED AT THE R.M.C. OFFICE OF GREENVILLE CO. IN PLAT BOOK GG-32 & 33.

LOT 41
N54-20E 164.8'

S54-20W 161.3'

LOT 43

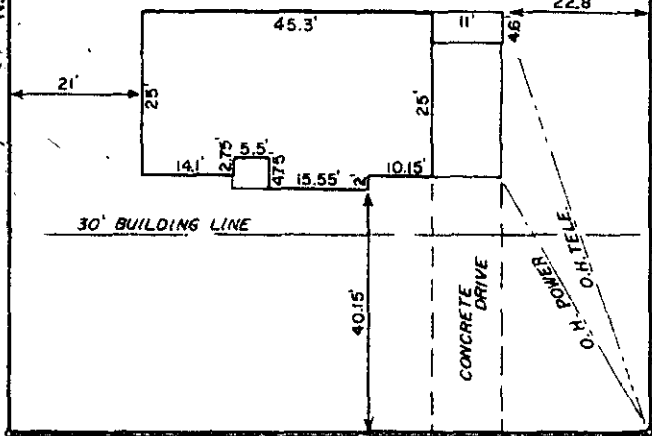

FILED
GREENVILLE CO. S.C.
JUN 8 10 44 AM '83
DONNIE S. TANKLISLEY
R.M.C.

SURVEY FOR
T. DANIEL STOGNER
GREENVILLE COUNTY, S.C.
MAY 18, 1983



SCALE 1"=30'

JUN 8 1983 9-U-4 33240

3.00CI
2 JUN 7 83 172

I certify that this is an accurate plat of a survey made by me May 18th, 1983, that the structures located on said premises do not encroach on adjacent streets or property, that no easements are shown on the ground except as noted hereon, and that the property is in a designated 100 year flood plain.

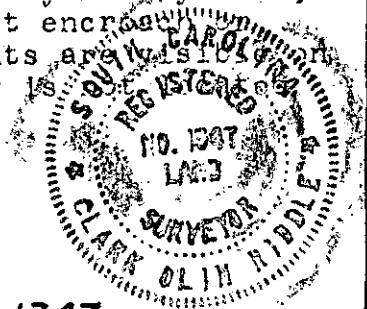

C. O. Riddle C.O. RIDDLE, S.C. REG. L.S. 1347