

GREENVILLE CO. S.C.
 APR 13 10 27 AM '83
 DONNIE S. TANKERSLEY
 R.M.C.

S 10-08 W →
 352.6

S 85-06 W →
 240.95

2.1 AC. ±

WELL
 O ← 34' →

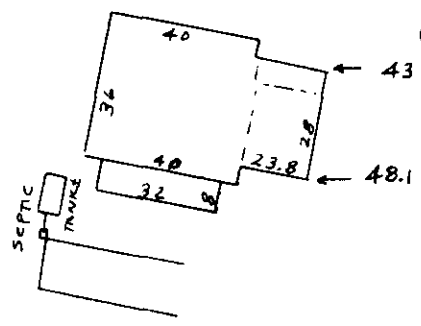

← N 15-06 E 517.26 TOTAL
 KOCH PROPERTY

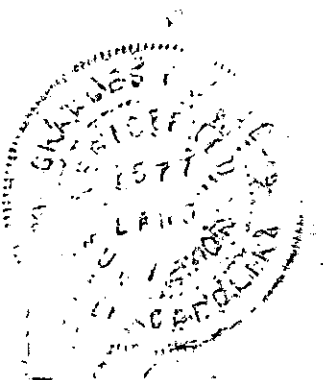

9-P. 45

← 145.63
 ← 547-00 E
 ALVERSON

Power Service Pole
 69.9
 ← 561-01 E

I hereby certify that on MAR. 30, 1983
 I rechecked the above survey which is
 a portion of lot 4 of the Nellie K.
 Hopkins estate; and that the property
 lines, buildings and walls are as shown
 hereon, that no walls or buildings
 encroach on adjacent streets or property
 and no buildings or walls encroach or
 project on these premises, and that
 the structures are not within a flood
 hazard area.

Charles F. Webb

Charles F. Webb PLS

PROPERTY OF
 RICHARD L. UMBAUGH
 and
 BRENDA C. UMBAUGH
 GREENVILLE COUNTY S.C.

WEBB SURVEYING & MAPPING Co.

SCALE: 1" = 50' MAR. 30, 1983

26496

THIS PLAT FOR RECORDING

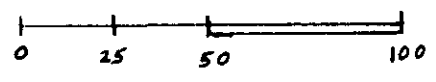

REVISED: NAME CHANGE

BLK. BK. REF. SBS-2-1-pt. 12

