

L-1	S 32-39-59 E	195.52	L-9	S 04-27-46 W	102.76	L-17	N 40-26-58 W	319.61	L-21	N 30-34-23 W	189.24
L-2	N 57-03-51 E	213.51	L-10	S 11-39-26 W	126.66	L-18	N 05-56-16 E	483.52	L-22	N 60-04-38 E	99.51
L-3	S 37-07-23 E	123.38	L-11	S 09-44-07 W	71.18	L-19	N 88-18-04 W	225.07	L-23	N 31-04-58 W	196.21
L-4	S 03-27-00 W	563.93	L-12	S 34-05-54 E	31.24	L-20	N 58-03-47 E	210.59	L-24	N 56-20-41 E	236.70
L-5	N 56-34-26 E	222.77	L-13	S 14-29-44 W	78.54						
L-6	S 05-35-32 W	191.05	L-14	S 16-52-58 W	135.78						
L-7	S 24-10-00 W	77.30	L-15	N 82-31-25 W	10.00						
L-8	S 05-37-04 W	11.24	L-16	N 82-31-25 W	246.91						

JEFF RICHARDSON JR. &  
JOSEPH H. McCULLOUGH JR.

FILED  
GREENVILLE CO. S.C.  
MAR 22 11 16 AM '83  
DONNIE S. TANKERSLEY  
R.M.C.  
FOUNTAIN INN CO.  
JONES JR.

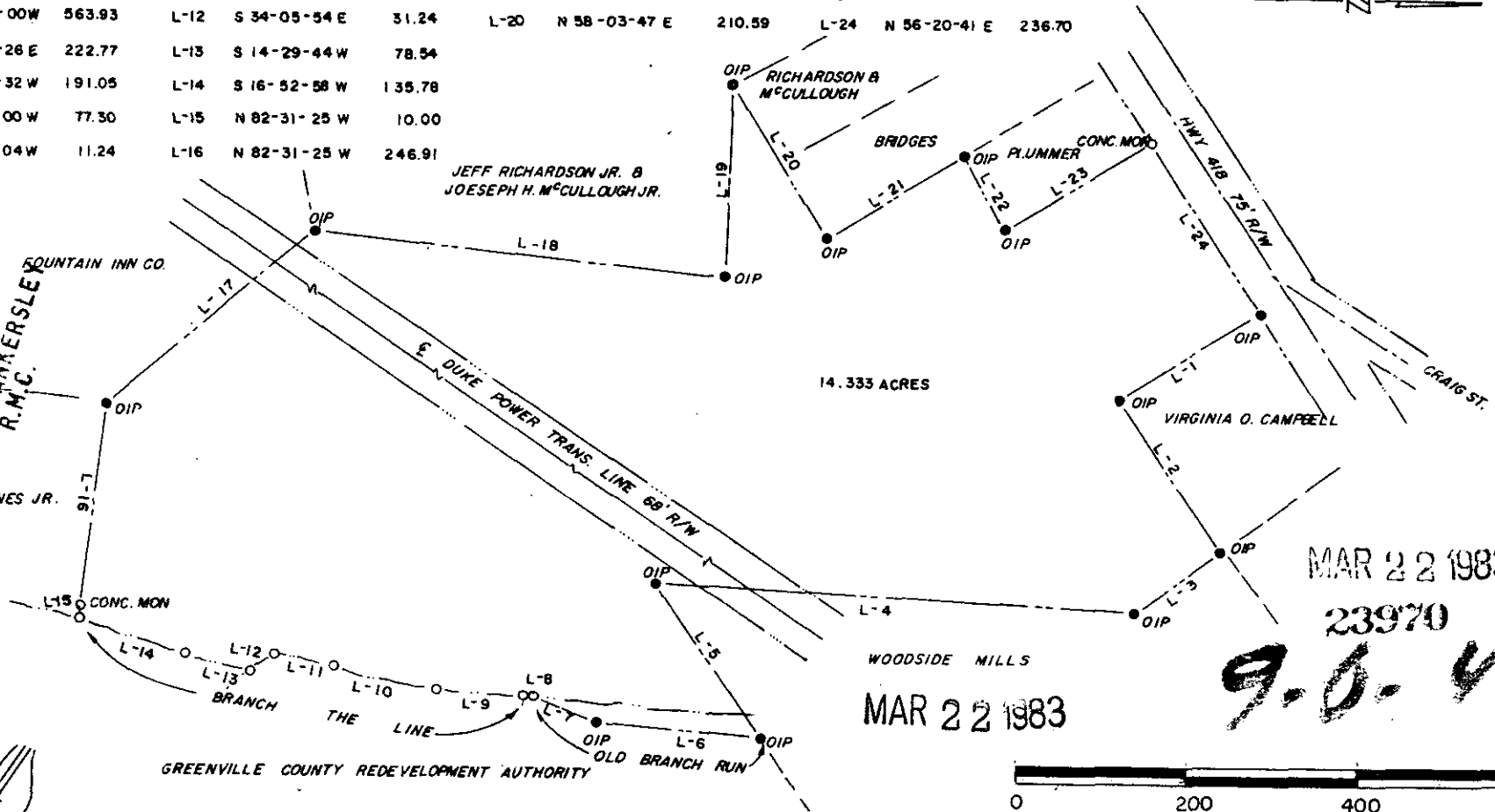

14.333 ACRES

WOODSIDE MILLS

MAR 22 1983

23970

9.0.48

MAR 22 1983

GREENVILLE COUNTY REDEVELOPMENT AUTHORITY

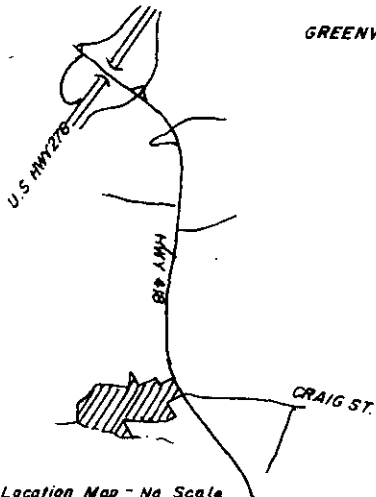

Location Map - No Scale

I HEREBY CERTIFY THAT THE PRECISION OF THE  
FIELD SURVEY IS 1:58,000 AND THE AREA WAS  
DETERMINED BY THE D.M.D. METHOD.

*Paul G. Wash*  
PAUL G. WASH Reg. L. 6. 3012  
SOUTH CAROLINA  
PAUL G. WASH

TRIPLE W CORP.

**W**

PH. 374-7290  
RT 2 BOX 514A

HODGES SC 29653

S.C. REGIONAL HOUSING AUTHORITY NO. 1  
LAURENS, S.C.

GREENVILLE COUNTY DATE FEB 1, 1983

SOUTH CAROLINA SCALE 1" = 200'

TOWNSHIP OF FOUNTAIN INN

MICROFILMED

3.0 P.C.I.