

AVICE DALE DRIVE

WATER & SEWER IN ST RIW.

MICROFILMED

N 32-23 E

O.I.P.

N 132

O.I.P.

LOCAL POWER SERVICE

MAG 1955

GERALD DECATHEAYN CORN

N 58-40 W 206.5

ASP DRIVE

20.2

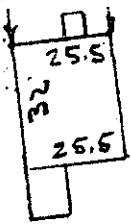

Note: Improvements on this lot are not in a flood hazard area.

TRACT A

LOCAL POWER SERVICE

214.0
S 47-44 E

EASLEY BRIDGE ROAD

S 35-31 W 96.0

ROBERT A. JUNE E. HAZARD

PROPERTY OF JOHN H HEMBREE & ANN M. HEMBREE NEAR GREENVILLE, S.C. SCALE 1" = 50' 1 MARCH 1983

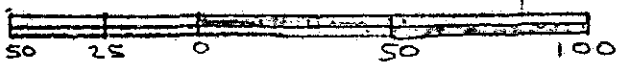

This is to certify that on the 1st day of March, 1983, I surveyed the property shown on this plat, being known as tract A on plat of PROPERTY OF N. Q. & MARTHA A. CLINE and recorded in the RMC Office Greenville County, S. C., in Plat Book " PP " at Page 7; and that the property lines, walls and buildings are as shown hereon, and that the walls and buildings located on said lot do not encroach or project on adjacent street or property, and that no adjacent walls or buildings encroach or project on said premises, and no power lines cross this property except as shown hereon.

10912572 8 002 2451101

FILED GREENVILLE CO. S.C. MAR 7 12 03 PM '83 DONNIE S. TANKERSLEY R.M.C.

MAR 7 1983 9N-95 22270

R. B. Bruce RLS #1952

CAROLINA SURVEYING CO. 112 Manly St. Greenville, S. C.

