

MICROFILMED

KEOWEE AVENUE

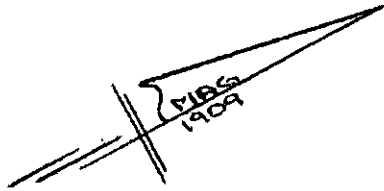

Note: Improvements on this lot are not in a flood hazard area.

- PT. 4 -

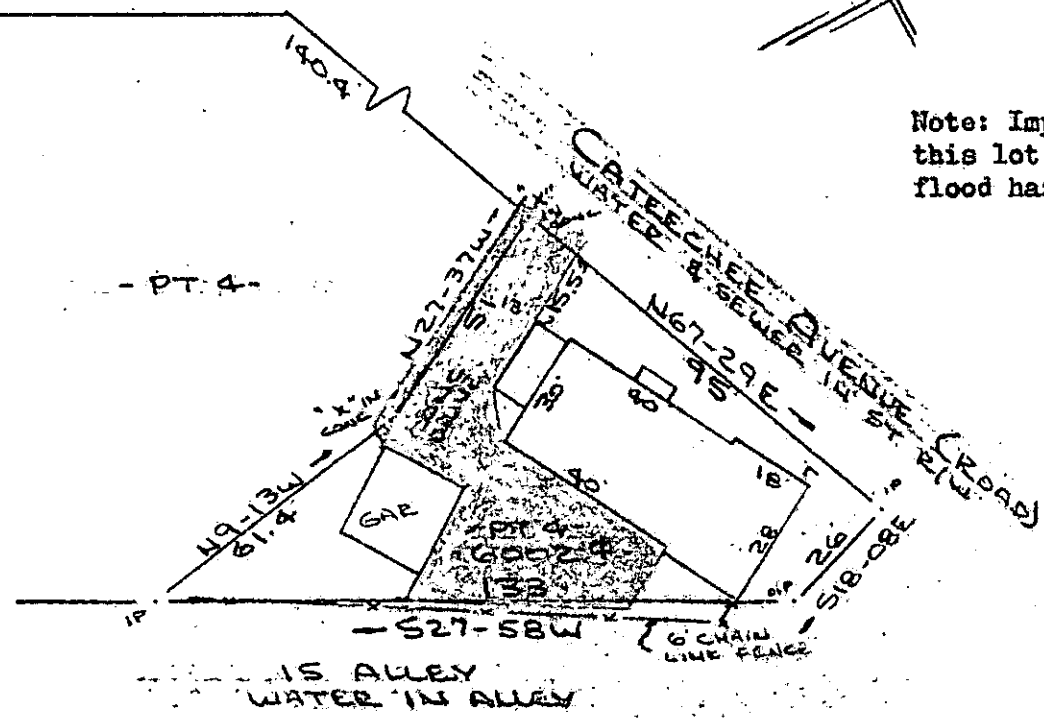

FILED
GREENVILLE CO. S. C.
MAR 1 3 12 PM '83
DONNIE S. TANKERSLEY
R. M. C.

PROPERTY OF
CHARLES JENKINSON, JR.
GREENVILLE, S. C.
SCALE 1" = 40' JULY 1982

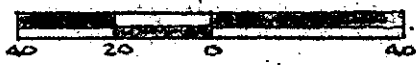

This is to certify that on the 1st day of July, 1982, I surveyed the property shown on this plat, being known as part of lot 4 on plat of CHEROKEE PARK and recorded in the RMC Office Greenville County, S. C., in Plat Book " C " at Page 96 and also being known as PROPERTY OF CHARLES JENKINSON, JR. and recorded in Plat Book at Page ; and that the property lines, walls and buildings are as shown hereon, and that the walls and buildings located on said lot do not encroach or project on adjacent street or property, and that no adjacent walls or buildings encroach or project on said premises, and no power lines cross this property except as shown hereon.

R. B. Bruce
R. B. Bruce, RLS #1952

21637

MAR 1 1983

9N-75

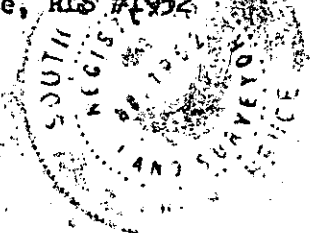

CAROLINA SURVEYING CO.
112 Manly St.
Greenville, S. C.
GCTO ----- 3 MR 1 83 080

3.0000