

THIS PLAT IS NOT A SUBDIVISION
AS DEFINED BY THE GREENVILLE
COUNTY SUBDIVISION REGULATIONS.

L. H. B. *F. J. Fisher*
Chairman, Secretary, or Director of
Planning,
Greenville County Planning Commission

PROPERTY OF -
BE & LL BROOKS,
J. F. & J. G. GILBERT,
& K. L. KIZER

NEAR GREENVILLE, S.C.
SCALE 1" = 50' JAN. 5, 1983



PIEDMONT ENGINEERS, ARCHITECT & PLANNERS
420 PARK AVE. GREENVILLE, S.C.

FILED
00. S. C.
FEB 17 10 28 AM '83
JOHN S. TANKERSLEY
R.M.C.

NOTE -
THIS PLAT COMPILED FROM
SURVEYS BY OTHERS.

20489
9-M-16
FEB 17 1983
Douglas S. Crowder
DOUGLAS S. CROWDER
REG. ENGR. & L.S. # 362

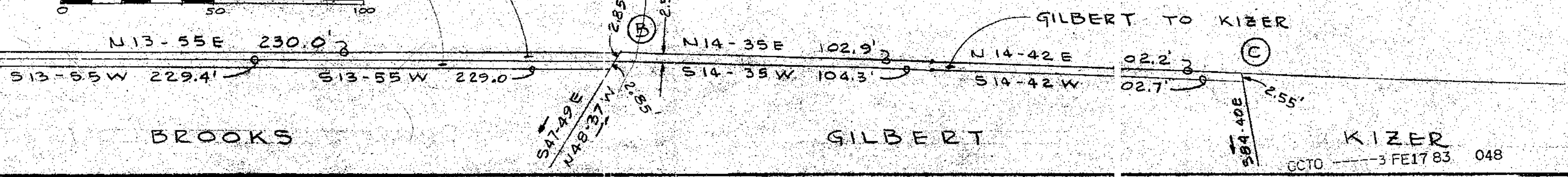

GCTO 3 FEB 17 83 048

MICROFILMED