

STEWART SQUARE
 (Sandra S. Cisson)

- PARCEL ① Greenville County to Jeffery D. & Susan Johnson
- PARCEL ② Sandra S. Cisson to Jeffery D. & Susan Johnson
- PARCEL ③ Sandra S. Cisson to Greenville County (New Owens Road)

- PARCEL ① = 0.147 Acres
 - PARCEL ② = 0.036 Acres
 - PARCEL ③ = 0.499 Acres
- 0.682 Acres

Plat Filed This 23 day of March 1983
 And Recorded in Vol. 9-F, page 58 at 2:59 P.M.
 Dennis A. Anderson
 Register of Deeds Greenville County

RECORDING FEE
 \$5.00

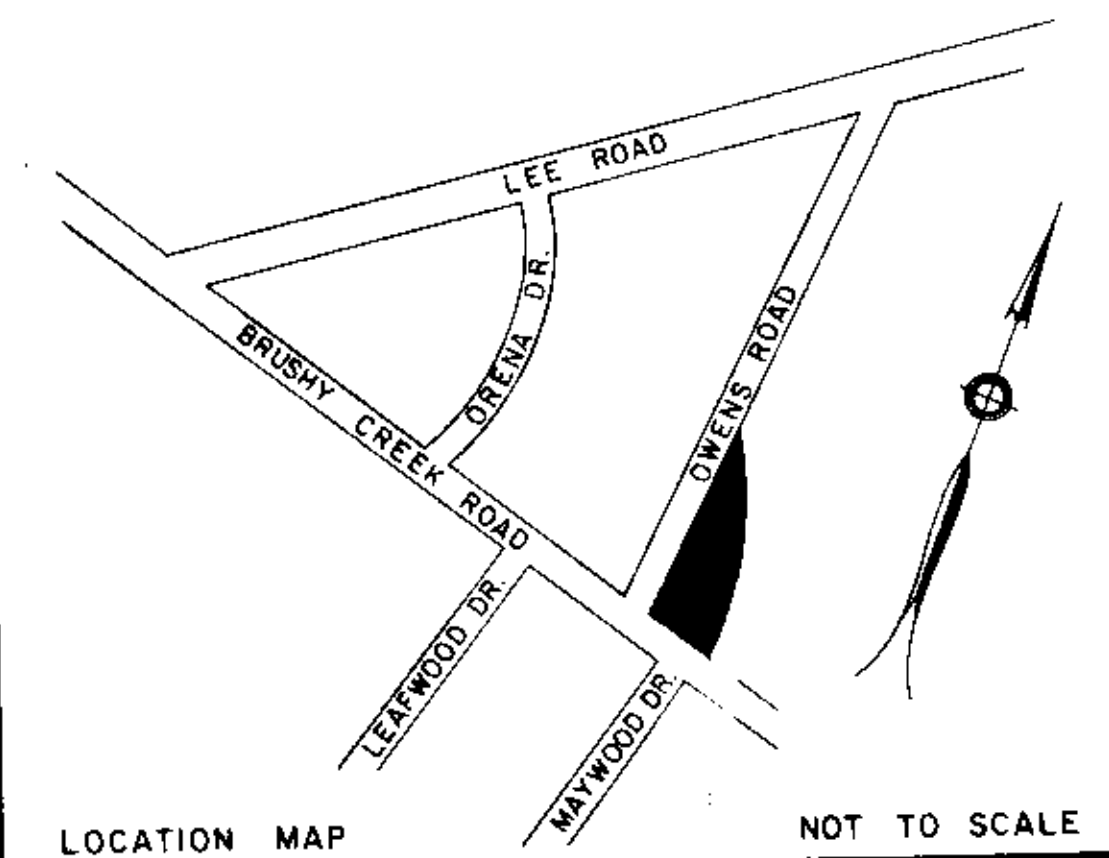

LOCATION MAP NOT TO SCALE

FINAL PLAT

CERTIFICATE OF OWNERSHIP AND DEDICATION

"The undersigned hereby acknowledge that I am (we are) the owner(s) of the property shown and described hereon and that I (we) hereby adopt this plan of subdivision with my (our) free consent and that I (we) establish the minimum building restriction lines, and hereby dedicate to public use as roads, streets, and easements, forever all areas so shown or indicated on said plat.

8 / 17 / 81 Signed Sandra S. Cisson
 / / / Signed _____
 / / / Signed _____
 / / / Signed _____

CERTIFICATE OF ACCURACY

"I, _____, certify that this plat was (drawn by me) (drawn under my supervision) (an actual survey made under my supervision) from (an actual survey made by me) (a deed description recorded in Book _____ Page _____ Book _____ Page _____, etc.) (other); that the error of closure as calculated by latitudes and departures is _____, that the boundaries not surveyed are shown as broken lines plotted from information found in Book _____ Page _____; that this plat was prepared in accordance with the Greenville County Subdivision Regulations as adopted.

8-17-81 DATE
 _____ LICENSED ENGINEER OR REGISTERED SURVEYOR
 S. C. Registration No. 6266

CERTIFICATE OF APPROVAL FOR RECORDING

"I hereby certify that the subdivision plat shown hereon has been found to comply with the Subdivision Regulations for Greenville County, with the exception of such variances, if any, as are noted in the minutes of the Greenville County Planning Commission of Greenville County, South Carolina, and that it has been approved for recording in the office of the County Register of Mens Conveyance."

3-23-83 DATE
 _____ DIRECTOR OF PLANNING
 GREENVILLE COUNTY PLANNING COMMISSION

FILE NUMBER

81-140

STEWART SQUARE

SANDRA S. CISSON OWNER
 DALTON & NEVES CO. ENGINEERS

NO. OF ACRES 0.682 MILES OF NEW ROAD 0.05

NO. OF LOTS 3 DATE August, 1981

ZONED C-IN

