

FILED  
NOV 25 1 41 PM '82  
CONNOR & WILKINSON  
S.C.

NOTES

1. ALL BUILDING LOCATION DIMENSIONS WERE MEASURED TO BUILDINGS IN FIELD
2. ALL INTERIOR ANGLES IN UNITS ARE 90° UNLESS OTHERWISE NOTED
3. EASEMENT EXIST TO DUKE POWER COMPANY, SOUTHERN BELL TELEPHONE COMPANY, AND TELECABLE OF GREENVILLE, INC. FOR SERVICE LINES TO BUILDINGS.
4. EACH UNIT CONSISTS OF THE SPACE BOUNDED BY THE UNDERCOATED AND UNFINISHED SURFACES OF THE PERIMETER WALLS, FLOORS, AND CEILINGS.
5. SEE ADDITIONAL SHEETS FOR FLOOR PLAN.
6. COMMON ELEMENTS -----
7. UNIT BOUNDARY \_\_\_\_\_
8. LIMITED COMMON ELEMENT // // // //

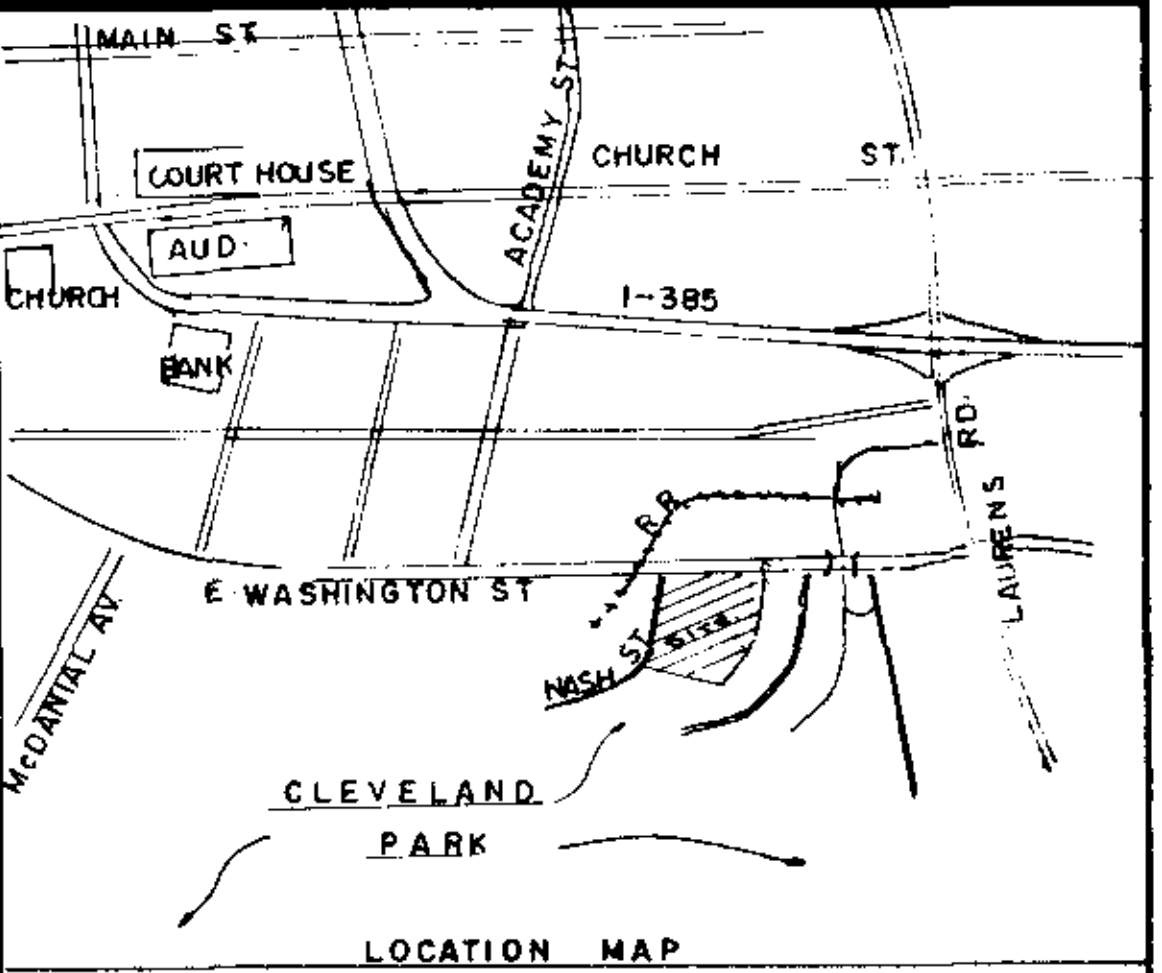
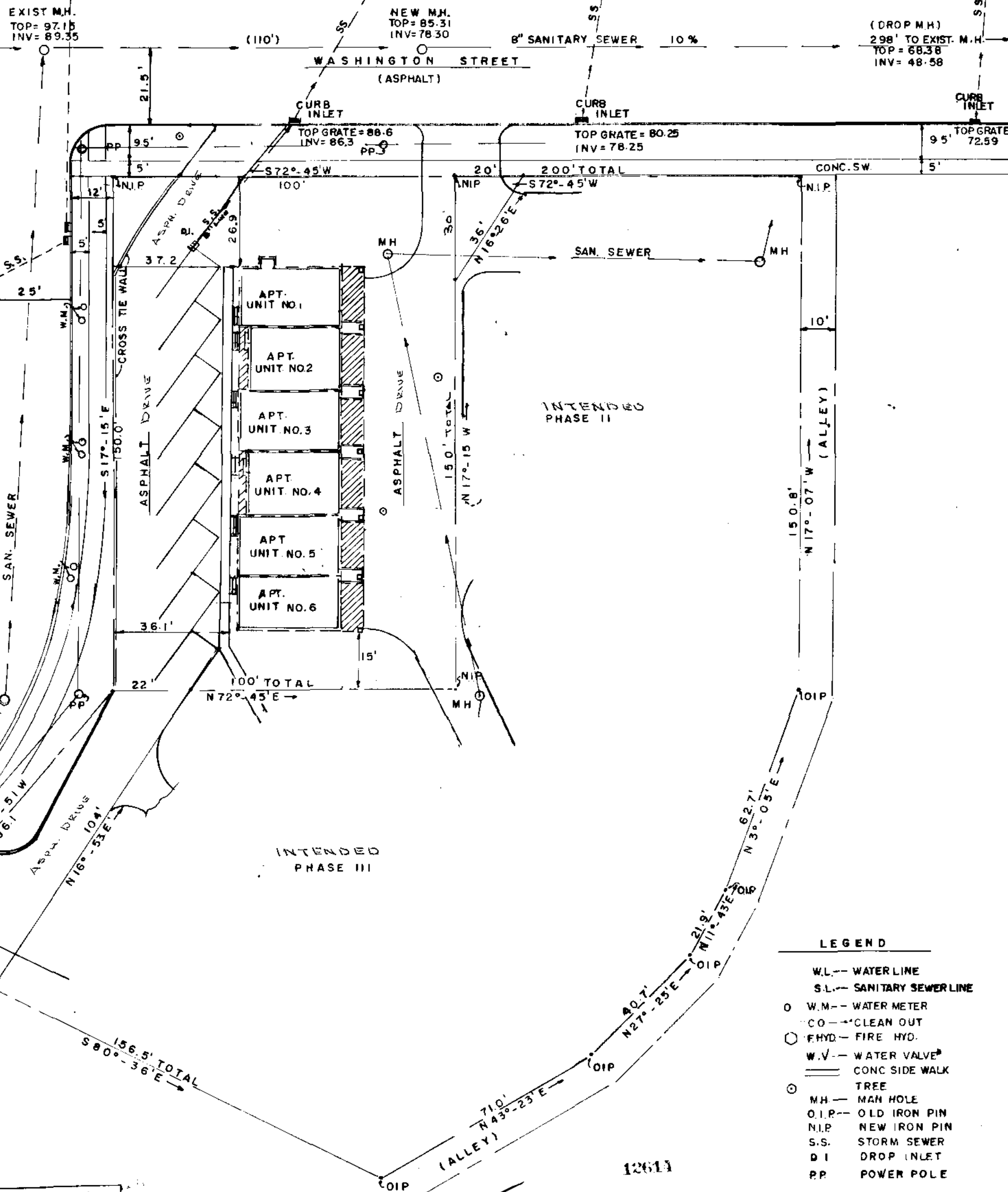

FINAL PLAT

CERTIFICATE OF OWNERSHIP AND DEDICATION

"The undersigned hereby acknowledge that I am (we are) the owner(s) of the property shown and described hereon and that I (we) hereby adopt this plan of subdivision with my (our) free consent and that I (we) establish the minimum building restriction lines, and hereby dedicate to public use as roads, streets, and easements, forever all areas so shown or indicated on said plat.

Signed \_\_\_\_\_  
Signed \_\_\_\_\_  
Signed \_\_\_\_\_  
Signed \_\_\_\_\_

CERTIFICATE OF ACCURACY

"I, KERNIT T. GOULD, certify that this plat was (drawn by me) (drawn under my supervision) (an actual survey made under my supervision) from (an actual survey made by me) (a description recorded in Book 1080, Page 838, Book 918, Page 225, etc.) (other); that the error of closure as calculated by latitudes and departures is 1/100.00, that the boundaries not surveyed are shown as broken lines plotted from information found in Book \_\_\_\_\_, Page \_\_\_\_\_, that this plat was prepared in accordance with the Greenville County Subdivision Regulations as adopted. ( B.L.K. BK. SH. 48-5-485) (PLT. BK. A PG. 183)

DATE \_\_\_\_\_  
KERNIT T. GOULD  
LICENSED ENGINEER OR REGISTERED SURVEYOR  
S.C. Registration No. 4035

CERTIFICATE OF APPROVAL FOR RECORDING

"I hereby certify that the subdivision plat shown hereon has been found to comply with the Subdivision Regulations for Greenville County, with the exception of such variances, if any, as are noted in the minutes of the Greenville County Planning Commission of Greenville County, South Carolina, and that it has been approved for recording in the office of the County Register of Mesne Conveyance."

DATE \_\_\_\_\_  
DIRECTOR OF PLANNING  
GREENVILLE COUNTY PLANNING COMMISSION

FILE NUMBER

WASHINGTON PARK EAST (PHASE I)

1200 EAST WASHINGTON STREET

WESCO INC. OWNER  
KERNIT T. GOULD ENGINEER OR SURVEYOR

NO. OF ACRES: 0.34 MILES OF NEW ROADS: 0

NO. OF LOTS: 1 DATE: 4-12-82

ZONE: Q-D  
SCALE: 1" = 20'

THIS PLAT IS NOT A SUBDIVISION AS DEFINED BY THE OR ENV. COUNTY SUBDIVISION REGULATIONS  
11/23/82  
F. J. Wilson  
Chairman, Secretary, or Member of Planning  
Greenville County Planning

9-F-28

THE DRIVES, PARKING AND ALL PAVED AREAS SHOWN HEREON ARE PRIVATE WITHIN THE WASHINGTON PARK EAST HORIZONTAL PROPERTY REGIME AS PERMANENT, EXCLUSIVE EASEMENT FOR THE OWNERS IN THE WASHINGTON PARK EAST PROPERTY REGIME, AND FOR THE PURPOSE OF INGRESS AND EGRESS, AND FOR THE PURPOSE OF MAINTAINING, REPLACING AND REPAIRING UTILITIES. A PUBLIC R/W WILL NOT BE MAINTAINED BY GREENVILLE CO., OR CITY OF GREENVILLE, UNLESS IMPROVED TO THEIR STD., DEDICATED TO THE PUBLIC, AND ACCEPTED BY GREENVILLE CO. OR CITY.

CERTIFICATE  
THIS IS TO CERTIFY THAT WE SURVEYED THE PROPERTY SHOWN ON THIS PLAT, AND THAT THE PROPERTY LINES AND BUILDINGS ARE AS SHOWN HEREON, THAT THE BUILDING LOCATED ON SHOWN PROPERTY DO NOT ENCR OACH OR PROJECT ON ADJACENT STREET OR PROPERTY, AND THAT NO ADJACENT BUILDINGS OR WALLS ENCR OACH OR PROJECT ON SHOWN PROPERTY, AND THAT BUILDING LOCATIONS ARE CORRECT.

Plat Filed This 23 day of Nov 1982  
And Recorded in Vol. 9-F, Page 28 on 1-11-83  
Register Mesne Conveyance Greenville County, S.C.

RECORDED  
PAGE 500