

MICROFILMED

N/F PALMETTO REAL ESTATE, TR.

WOOLWORTH'S STORE

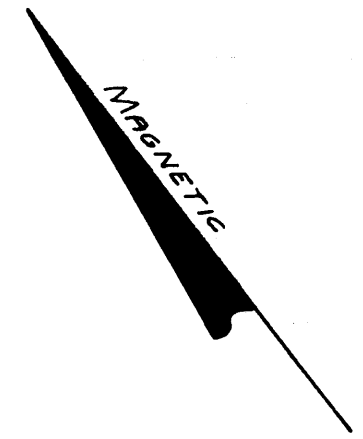

N/F PALMETTO REAL ESTATE, TR.

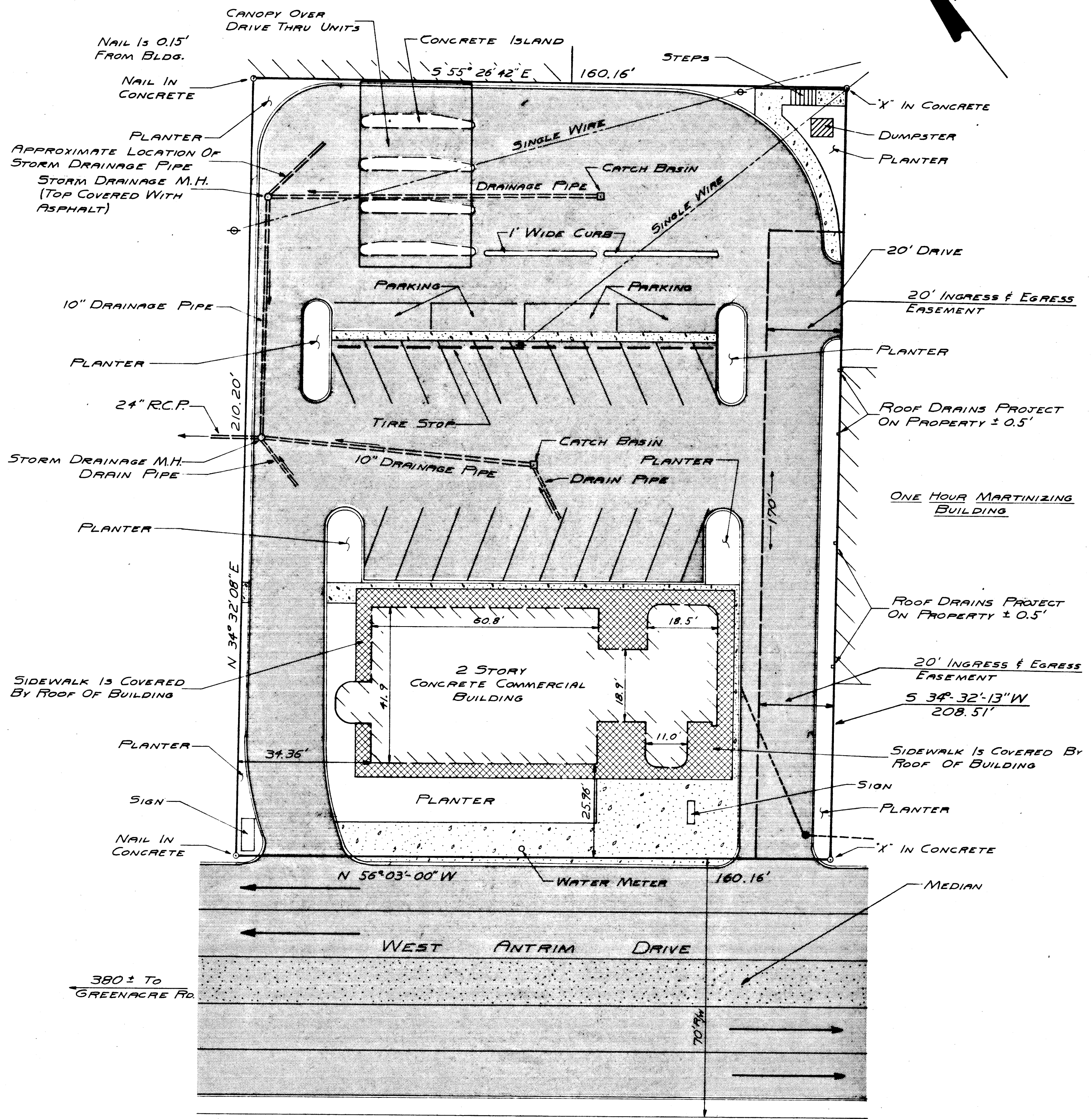

LEGEND

- CONCRETE SIDEWALK
- OVERHEAD UTILITY WIRE
- UTILITY POLE
- SIDEWALK COVERED BY BUILDING ROOF
- CURB
- ASPHALT PAVEMENT
- SANITARY SEWER M.H. & SERVICE LINE

- NOTES.
1. AREA OF THIS TRACT IS 0.77 AC.
  2. THE SAME BEING SHOWN ON A PLAT OF PLEASANTBURG SHOPPING CENTER BY PIEDMONT ENGINEERS AND ARCHITECTS DATED DECEMBER 2, 1963 AND REVISED FEBRUARY 4, 1964. THE PLAT IS RECORDED IN THE OFFICE OF THE REGISTER, GREENVILLE COUNTY IN PLAT BOOK YY AT PAGE 161.
  3. I HEREBY CERTIFY THAT THESE MEASUREMENTS ARE CORRECT AS SHOWN AND THAT THERE ARE NO ENCROACHMENTS OR PROJECTIONS OTHER THAN SHOWN.
  4. I HEREBY CERTIFY THAT THE RATIO OF PRECISION OF THE FIELD SURVEY IS 1/10,000 AS SHOWN HEREON AND WAS DETERMINED BY D.M.D. METHOD.
  5. SANITARY SEWER M.H. AND SERVICE LINE LOCATION IS TAKEN FROM A PLOT PLAN BY J.E. SIRRINE CO. DATED AUG 16, 1968 FOR PLEASANTBURG BRANCH, PEOPLES NATIONAL BANK.
  6. BEARING ON WEST ANTRIM DRIVE (N 56°03'00"W REFERENCE BEARING) TAKEN FROM A PLAT BY PIEDMONT ENGINEERS & ARCHITECTS DATED AUG. 30, 1968 REVISED JULY 28, 1981.

11315  
8-4-23

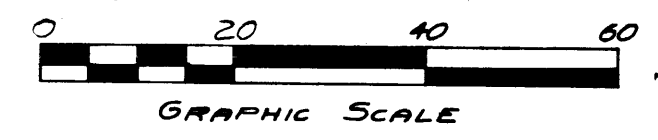

NOV 5 1981

REVISED: OCTOBER 27, 1981

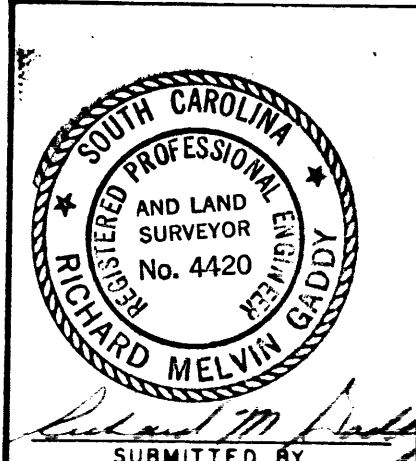

SURVEY FOR

BANKERS TRUST OF SOUTH CAROLINA

CITY OF GREENVILLE

GREENVILLE COUNTY, SOUTH CAROLINA

R. M. GADDY AND ASSOCIATES  
CONSULTING ENGINEER  
COLUMBIA, S. C.

DESIGNED BY	
DRAWN BY	M.G.
CHECKED BY	R.M.G.
SCALE	1"=20'
DATE	9-25-81
SHEET NO	1
OF	1 SHEETS

FILED  
GREENVILLE CO. S.C.  
NOV 5 2 45 PM '81  
DONNIE S. TANKERSLEY  
R.M.C.

500 8 6621801