

FILED  
GREENVILLE CO. S.C.  
OCT 9 3 34 AM '81  
DONNIE S. TANKERSLEY  
R.M.C.

FILED  
GREENVILLE CO. S.C.  
OCT 9 3 34 AM '81  
DONNIE S. TANKERSLEY  
R.M.C.

WINDING WAY

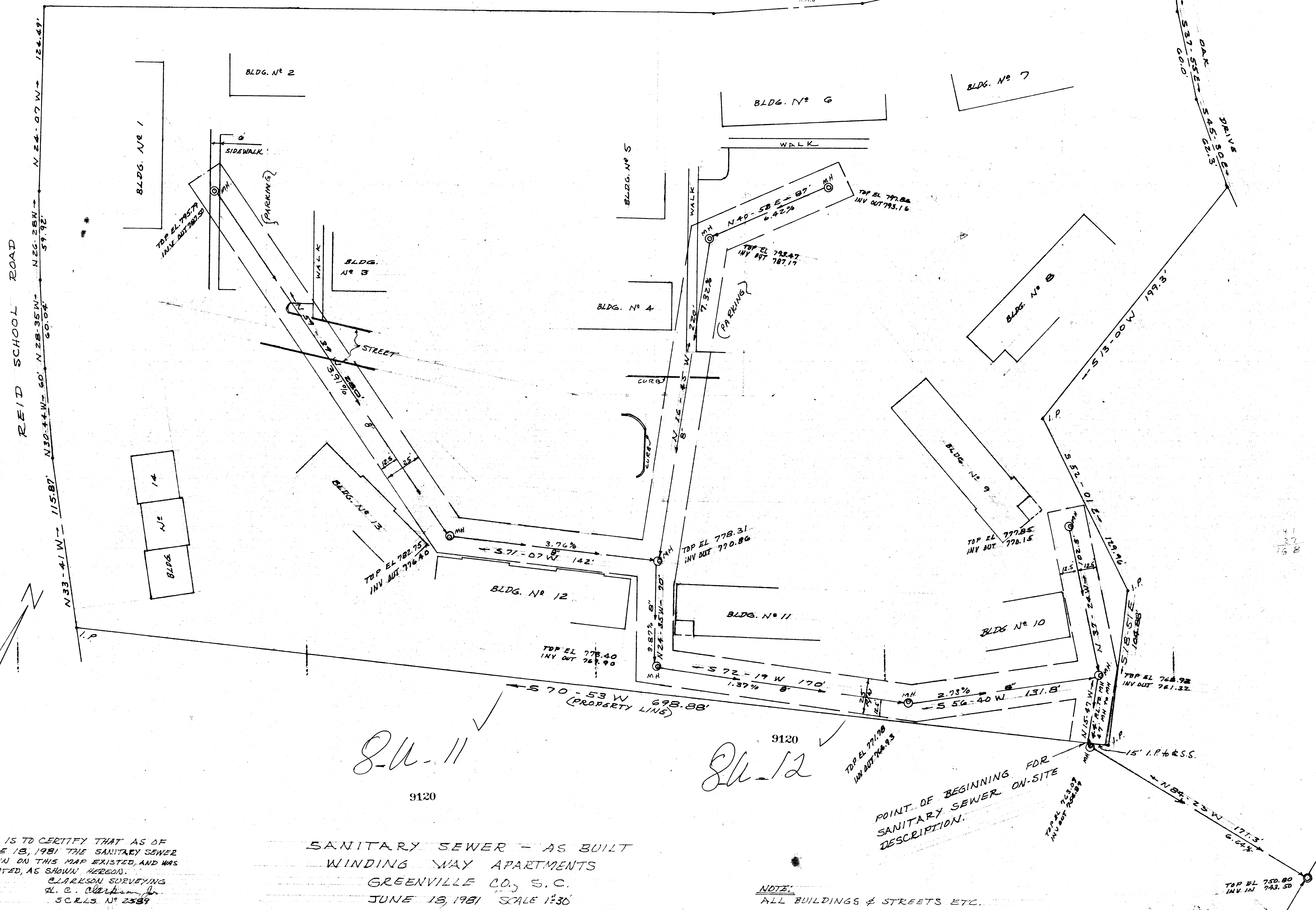

9120  
S-U-11

9120  
S-U-12

POINT OF BEGINNING FOR  
SANITARY SEWER ON-SITE  
DESCRIPTION.

THIS IS TO CERTIFY THAT AS OF  
JUNE 18, 1981 THE SANITARY SEWER  
SHOWN ON THIS MAP EXISTED, AND WAS  
SITUATED, AS SHOWN HEREON.  
CLARKSON SURVEYING  
L. C. Clarkson, Jr.  
S.C.L.S. NO. 2389

SANITARY SEWER - AS BUILT  
WINDING WAY APARTMENTS  
GREENVILLE CO., S.C.  
JUNE 18, 1981 SCALE 1"=30'

NOTE:  
ALL BUILDINGS & STREETS ETC.  
UNDER CONSTRUCTION - ALL  
BUILDING FOUNDATIONS EXIST.