

MICROFILMED

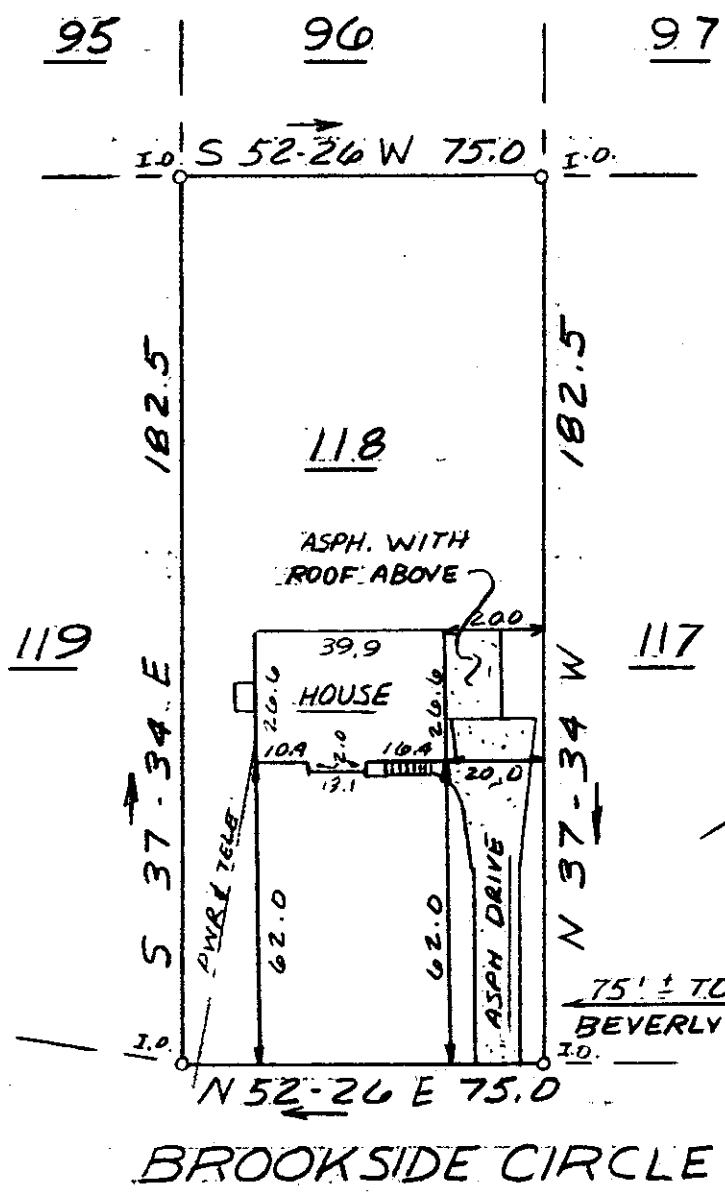
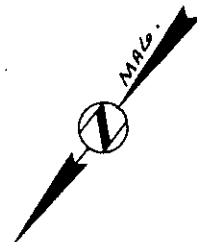

This is to certify that on August 24, 1981, I surveyed the property shown on this plat, known as Lot 118 on plat of University Park, recorded in the RMC Office of Greenville County in Plat Book P on page 127, and that the property lines, walls and buildings are as shown hereon; that the building located on said lot does not encroach or project on adjacent streets or property, and that no adjacent walls or buildings encroach or project on said premises, and that no utility lines cross this property except as shown hereon. This property is not located in a designated flood hazard area.

*James R. Freeland*  
James R. Freeland RLS & PE 4781

SEP 18 3 31 PM '81  
DONNIE S. TANKERSLEY  
R.M.C.

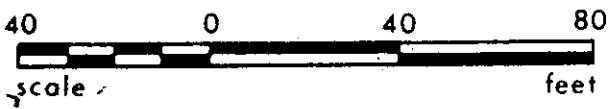

7251  
8-T-49



**STATE OF SOUTH CAROLINA  
GREENVILLE COUNTY**

UNIVERSITY PARK  
LOT 118  
PROPERTY OF  
FAROUK RIZK

FREELAND & ASSOCIATES  
Engineers • Land Surveyors  
GREENVILLE, S.C.

SURVEY	LT
DRAWN	MES
CHECK	MLL
SCALE	1" = 40'
DATE	8-24-81
DWG. NO.	6811

PRINT 4808 8 3000

FILED  
SEP 18 1981  
GREENVILLE, S.C.