

MICROFILMED

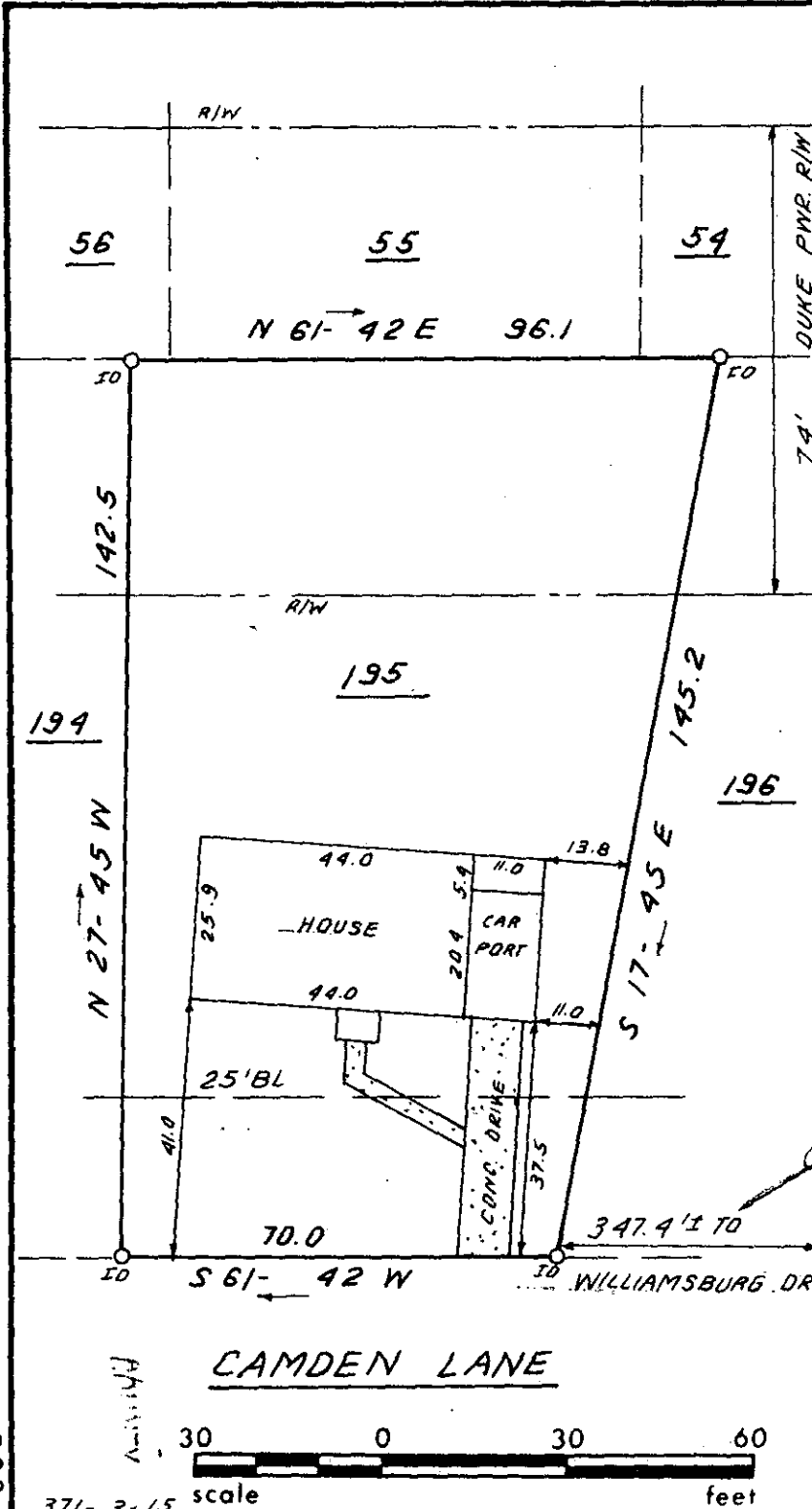

This is to certify that on July 8, 1981, I surveyed the property shown on this plat, known as Lot 195 on plat of Belle Meade Sec. 1 & 2, recorded in the RMC Office of Greenville County in Plat Book EE on page 117, and that the property lines, walls and buildings are as shown hereon; that the building located on said lot does not encroach or project on adjacent streets or property, and that no adjacent walls or buildings encroach or project on said premises, and that no utility lines cross this property except as shown hereon. This property is not located in a designated flood hazard area.

5' drainage and utility easement along all side and rear lot lines.

James R. Freeland
James R. Freeland RLS & PE 4781

1170
8-5-4

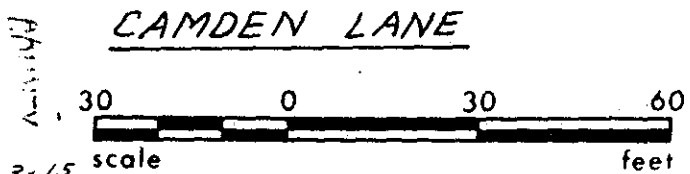

300 8 252 08B 0142W 1212

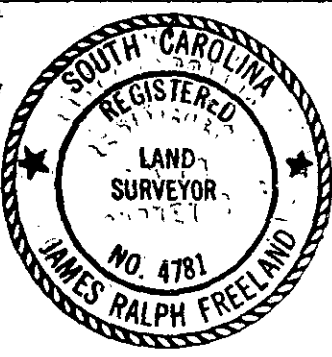

**STATE OF SOUTH CAROLINA
GREENVILLE COUNTY**

BELLE MEADE
SEC. 1 & 2; LOT 195
PROPERTY OF
PRESTON A. POSLEY
DEBORAH B. POSLEY

FREELAND & ASSOCIATES
Engineers • Land Surveyors

GREENVILLE, S.C.

SURVEY JRF

DRAWN BR

CHECK MLC

SCALE 1" = 30'

DATE JULY 8, 81

DWG. NO. 6856