

8N.78

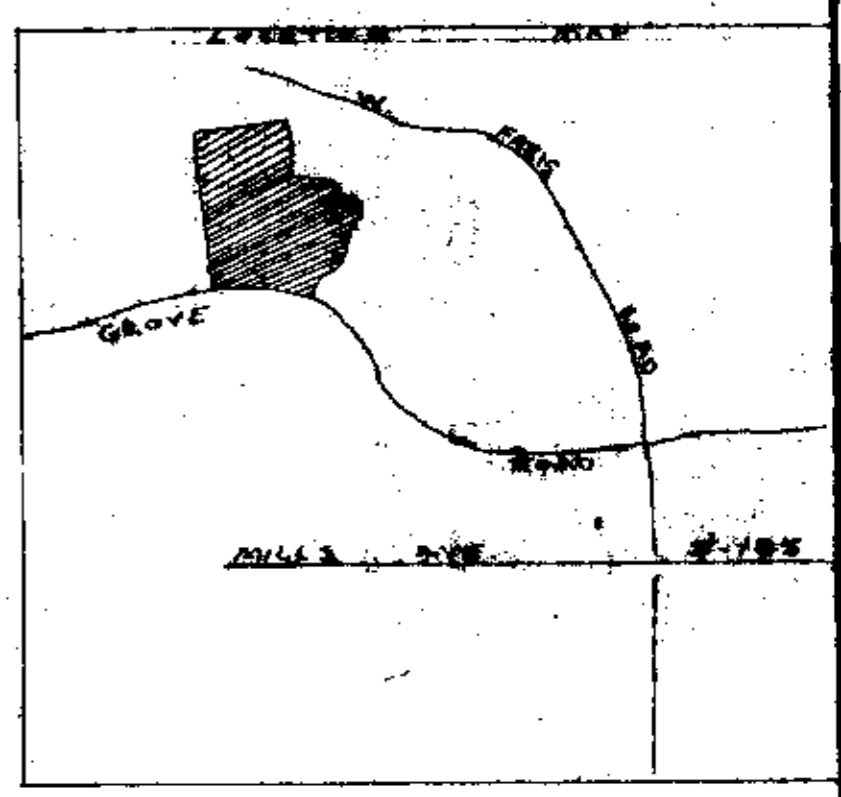

THIS PLAT IS NOT A SUBDIVISION
 AS DEFINED BY THE GREENVILLE
 COUNTY SUBDIVISION REGULATIONS.
 6/25/81 *Charles F. Webb*
 Director of
 Planning,
 Greenville County Planning Commission

35756

8N.79

TRACT "A"
 TOTAL AREA 42.836
 ROAD R/W 10.12
 SAN SEWER AND WATER LINE R/W 2.32 AC.
 CITY SAN SEWER = EASEMENT ONLY
 FLOOD PLAIN AREA 6.43 AC.
 (NOT WITHIN R/W) = 5.36 AC.

TRACT "B"
 TOTAL AREA = 2.157 AC.
 ROAD R/W = 0.22 AC.
 NET AREA = 1.937 AC.
 SAN SEWER AND WATER LINE R/W = 0.81 AC.
 FLOOD PLAIN AREA = 0.69
 (NOT WITHIN R/W) = 0.62

TRACT "C"
 TOTAL AREA 10.837 AC.

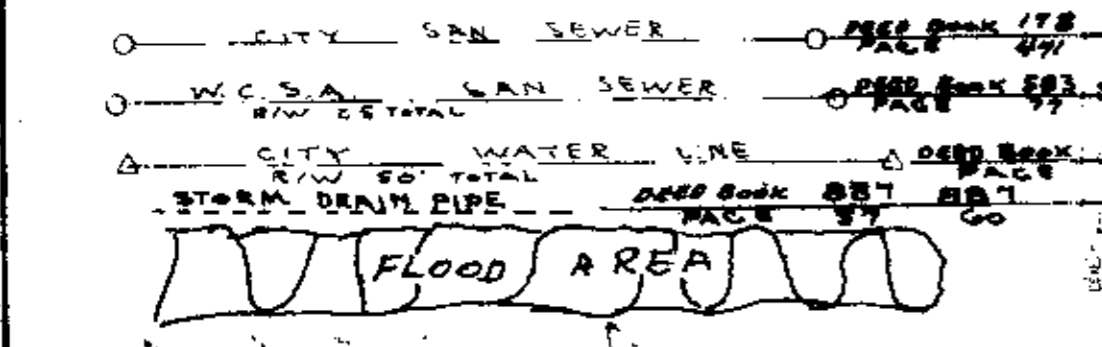

REGISTERED
 1577
 LAND SURVEYOR
 CHARLES F. WEBB
 SOUTH CAROLINA

Charles F. Webb
 Charles F. Webb RLS

PROPERTY OF
AMERICAN SERVICE CORP.

IN THE CITY OF GREENVILLE
 GREENVILLE COUNTY S. C.
 WEBB SURVEYING & MAPPING CO.
 SCALE 1" = 100' MAY 14, 1981

IN THE CITY OF GREENVILLE
 GREENVILLE COUNTY S. C.
 WEBB SURVEYING & MAPPING CO.
 SCALE 1" = 100' MAY 14, 1981

5299-122