

MICROFILMED

WILMONT WATER & SEWER LANE IN ST R/W

AUGUSTA RD.

CO. S. C.
Nov 19 9 32 AM '80
DONNIE STANKERSLEY
R.M.C.

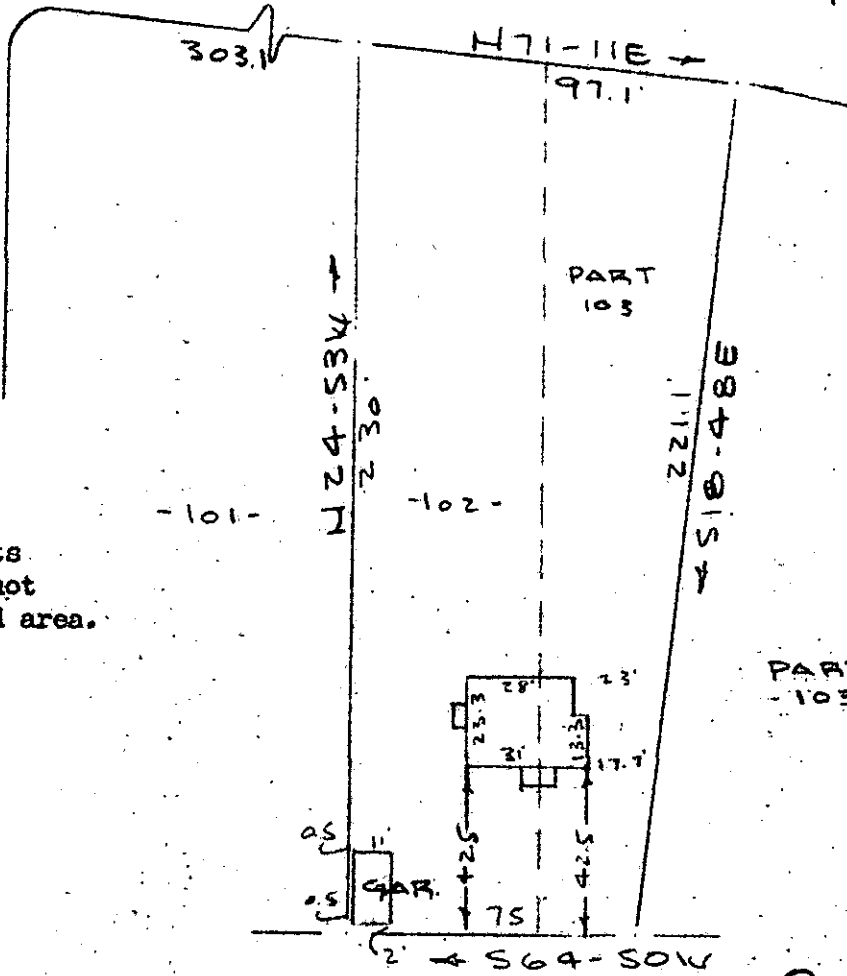

Note: Improvements on this lot are not in a flood hazard area.

8-H-85

PROPERTY OF HARRY L. MORRISON GREENVILLE, S. C.

SCALE: 1" = 50' 4 NOV 1980

This is to certify that on the 4th day of November, 1980, I surveyed the property shown on this plat, being known as lot 102 & part of lot 103 on plat of COUNTRY CLUB ESTATES and recorded in the RMC Office Greenville County, S. C., in Plat Book " G " at Page 191 and also known as PROPERTY OF HARRY L. MORRISON and recorded in the RMC Office Greenville County, S. C., in Plat Book at Page ; and that the property lines, walls and buildings are as shown hereon, and that the walls and buildings located on said lot do not encroach or project on adjacent street or property, and that no adjacent walls or buildings encroach or project on said premises, and no power lines cross this property except as shown hereon.

15540

R. B. Bruce
R. B. Bruce, RLS #1952

NOV 19 1980

CAROLINA SURVEYING CO.
112 Manly St.
Greenville, S. C.

GREENVILLE FILED

GCTO -----3 NO 1980

3.00CI

230/19

211-6-13