

Note: Improvements on this lot are not in a flood hazard area.

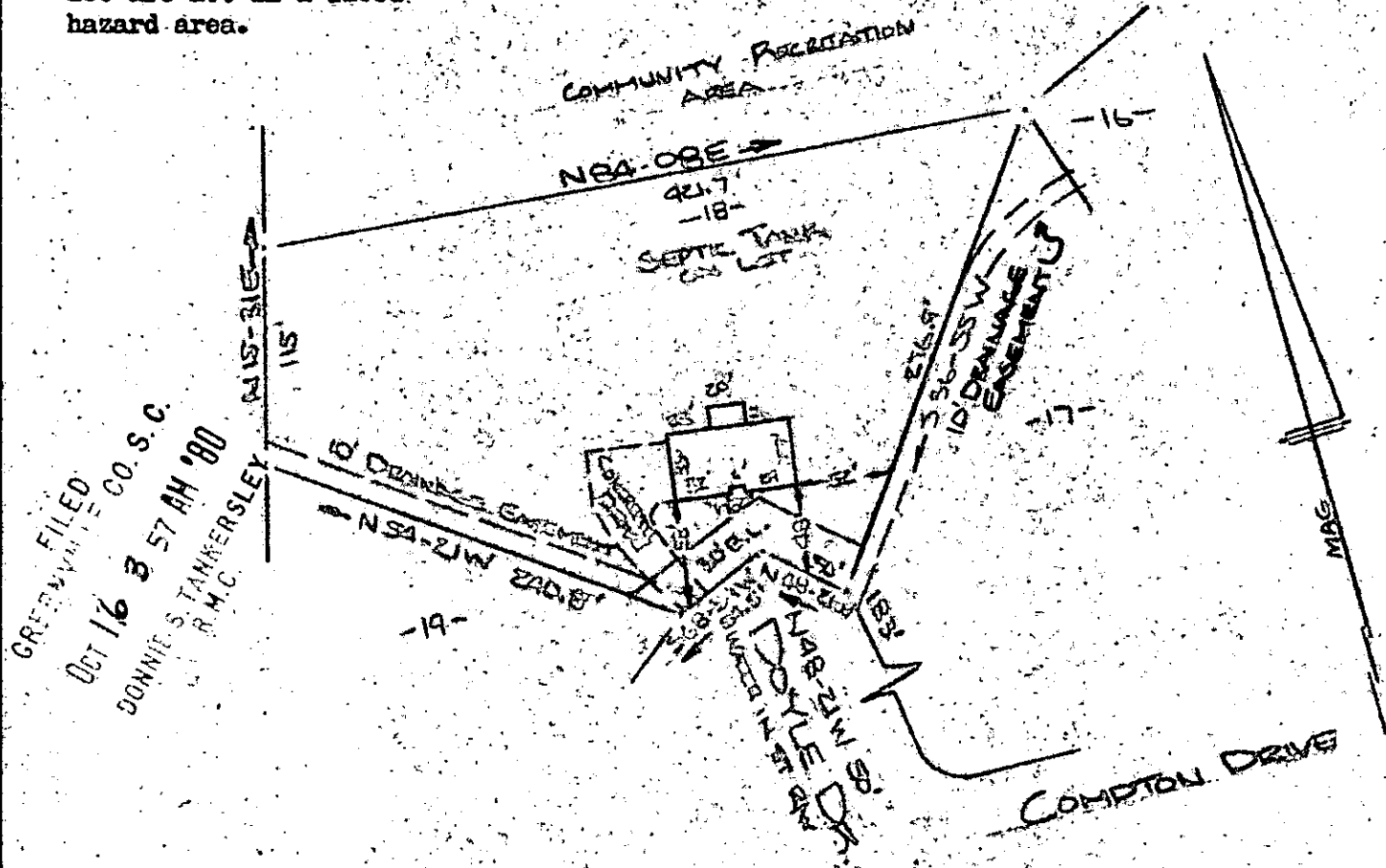

PROPERTY OF
FREDERICK S. BIESECKER & YNEMA G. BIESECKER
 NEAR GREENVILLE, S.C.
 SCALE 1"=400' OCT 1980

This is to certify that on the 7th day of October, 1980, I surveyed the property shown on this plat, being known as lot 18 on plat of MAP OF TERRA PINES ESTATES SECTION NO. 4 and recorded in the RMC Office Greenville County, S. C., in Plat Book "000" at Page 85; and that the property lines, walls and buildings are as shown hereon, and that the walls and buildings located on said lot do not encroach or project on adjacent street or property, and that no adjacent walls or buildings encroach or project on said premises, and no power lines cross this property except as shown hereon.

R. B. Bruce
 R. B. Bruce, PLS # 1952

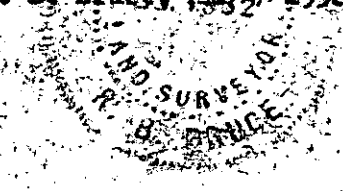

CAROLINA SURVEYING CO.
 112 Manly St.
 Greenville, S. C.

12007

8-G-86

GC10 --- 1 OCT 16 80 913 3:00CI