

"THIS PROPERTY IS NOT LOCATED IN A FLOOD PLAIN."

*J.L. Montgomery*

MICROFILMED

FILED  
GREENVILLE CO. S. C.  
OCT 13 4 47 PM '80  
DONNIE S. TANKERSLEY  
R.M.C.

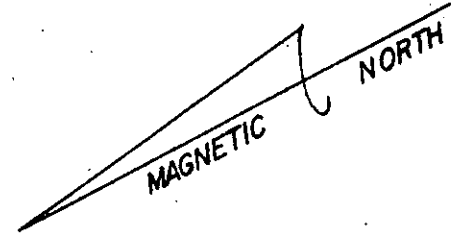
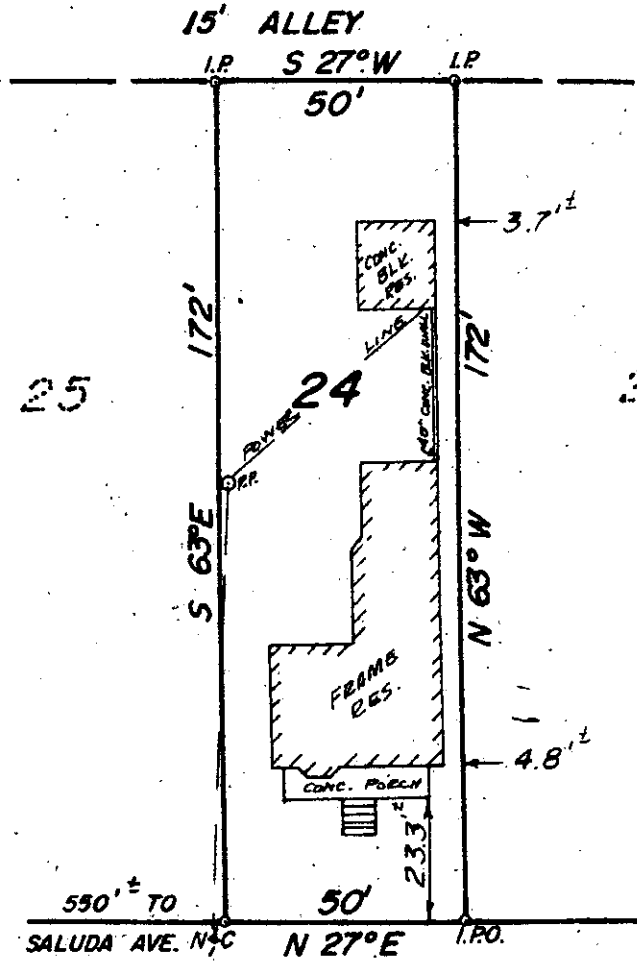

NOTE: WATER & SEWER IN STREET R/W.

11616

✓ 18-G-77

OCT 13 1980

# KEOWEE AVENUE

SCALE: 1" = 40'  
CITY OF GREENVILLE, SOUTH CAROLINA

THIS IS TO CERTIFY THAT ON THE 8<sup>th</sup> DAY OF OCTOBER 1980, I SURVEYED THE PROPERTY SHOWN ON THIS PLAT, BEING KNOWN AS LOT 24-S (portion) ON PLAT OF CHEROKEE PARK, AND RECORDED IN THE R. M. C. OFFICE GREENVILLE COUNTY, S. C. IN PLAT BOOK A AT PAGE 130; AND THAT THE PROPERTY LINES, WALLS, AND BUILDINGS ARE SHOWN HEREON, AND THAT THE WALLS AND BUILDINGS LOCATED ON SAID LOT DO NOT ENCROACH OR PROJECT ON ADJACENT STREETS OR PROPERTY, AND THAT NO ADJACENT WALLS OR BUILDINGS ENCROACH OR PROJECT ON SAID PREMISES, AND NO POWER LINES CROSS THIS PROPERTY EXCEPT AS SHOWN HEREON.

"THIS IS TO CERTIFY THAT THE ERROR OF CLOSURE OF THIS SURVEY IS 1 IN 10,000, AND THE ACREAGE HAS BEEN DETERMINED BY THE D.M.D. METHOD."

*J.L. Montgomery*  
OCT 13 80

REGISTERED  
J.L. MONTGOMERY, III  
R.L.S. No. 4552  
Simpsonville, S.C.

289