

MICROFILMED

KNOLLVIEW DRIVE

-95-

S85.57E
121.0'

-62-

-61-

-60-

N 3-11 W 141.2

S 3-11 E 126.0'

50 BUILDING LINE

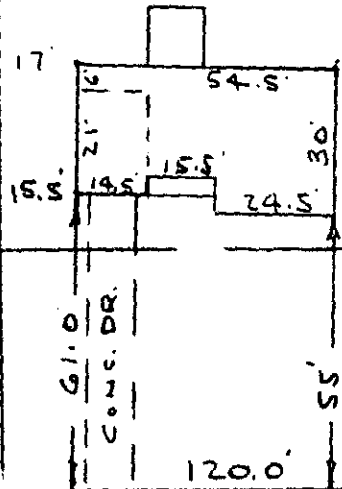

S86.49W

SOUTH VALLEY LANE

WATER & SEWER IN ST R/W.

Note:
Improvements on this lot are not in a flood hazard area.

PROPERTY OF
 CHARLES D. COBB JR & KAREN H. COBB
 NEAR GREENVILLE, S.C.
 SCALE 1" = 40' 19 AUG. 1980

This is to certify that on the 19th day of August, 1980, I surveyed the property shown on this plat, being known as lot 61 on plat of MAP OF RIVERDALE and recorded in the RMC Office Greenville County, S. C., in Plat Book "KK" at Page 107; and that the property lines, walls and buildings are as shown hereon, and that the walls and buildings located on said lot do not encroach or project on adjacent street or property, and that no adjacent walls or buildings encroach or project on said premises, and no power lines cross this property except as shown hereon.

✓ 8-D-48

5177

R. B. Bruce
 R. B. Bruce, RLS #1952
 AUG 20 1980
 GREENVILLE CO. S.C.

FILED
 GREENVILLE CO. S.C.
 AUG 20 11 54 AM '80
 DONNIE S. TANKERSLEY
 R.M.C.

AUG 20 1980
 CAROLINA SURVEYING CO.
 Greenville, S.C.

3.0001

226/52

239.1 5-17