

93-1-42

MAG. NORTH

MICROFILMED

S1-50 W 60.0

I.N. I.N.

28' ALLEY (ABANDONED)

N 89-40 E

S 89-40 W

93-1-40

This is to certify that on April 22, 1980, I surveyed the property shown on this plat, known as Property of Thelma W. Godfrey, recorded in the RMC Office of Greenville County in Deed Book 278 on page 20, and that the property lines, walls and buildings are as shown hereon; that the building located on said lot does not encroach or project on adjacent streets or property, and that no adjacent walls or buildings encroach or project on said premises, and that no utility lines cross this property except as shown hereon. This property is not located in a designated flood hazard area.

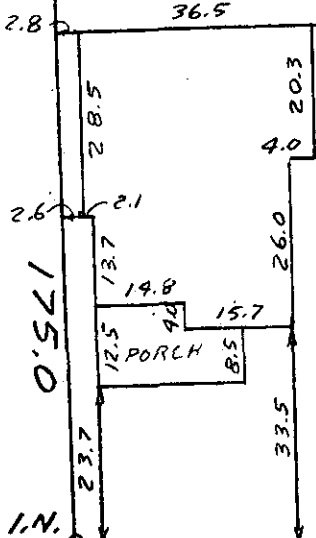

ENCROACHMENT WOOD GARAGE

ENCROACHMENT ALUM. BLDG.

James R. Freeland
 James R. Freeland RLS & PE
 4781

FILED
 GREENVILLE CO. S.C.
 APR 25 4 00 PM '80
 DONNIE S. TANKERSLEY
 R.M.C.

N1-50E 60.0 295' TO

HOUSTON STREET TINDAL AVE

APR 25 1980

31547

7-2-38 ✓

GCTO -----3 AP 25 80

(BLK. BK. 93-1-41)



SEAL

STATE OF SOUTH CAROLINA
 GREENVILLE COUNTY

FREELAND & ASSOCIATES
 Engineers • Land Surveyors

GREENVILLE, S.C.

PROPERTY OF

CALVIN SULLIVAN
 MARY ANN WILLIAMS

SURVEY	L.T.
DRAWN	J.R.F.
CHECK	MC
SCALE	1" = 30'
DATE	4-22-80
DWG. NO.	80-4993