

TOTAL PARCEL		
A-1	586-03-362	470.94
A-2	586-03-362	470.94
A-3	586-03-362	470.94
A-4	586-03-362	470.94
B-1	586-03-362	470.94
B-2	586-03-362	470.94
B-3	586-03-362	470.94
B-4	586-03-362	470.94
B-5	586-03-362	470.94
B-6	586-03-362	470.94
B-7	586-03-362	470.94
B-8	586-03-362	470.94
B-9	586-03-362	470.94
B-10	586-03-362	470.94
B-11	586-03-362	470.94
B-12	586-03-362	470.94
C-1	586-03-362	470.94
C-2	586-03-362	470.94
C-3	586-03-362	470.94
C-4	586-03-362	470.94
C-5	586-03-362	470.94
C-6	586-03-362	470.94
C-7	586-03-362	470.94
C-8	586-03-362	470.94
C-9	586-03-362	470.94
C-10	586-03-362	470.94
C-11	586-03-362	470.94
C-12	586-03-362	470.94
D-1	586-03-362	470.94
D-2	586-03-362	470.94
D-3	586-03-362	470.94
D-4	586-03-362	470.94
D-5	586-03-362	470.94
D-6	586-03-362	470.94
D-7	586-03-362	470.94
D-8	586-03-362	470.94
D-9	586-03-362	470.94
D-10	586-03-362	470.94
D-11	586-03-362	470.94
D-12	586-03-362	470.94
E-1	586-03-362	470.94
E-2	586-03-362	470.94
E-3	586-03-362	470.94
E-4	586-03-362	470.94
E-5	586-03-362	470.94
E-6	586-03-362	470.94
E-7	586-03-362	470.94
E-8	586-03-362	470.94
E-9	586-03-362	470.94
E-10	586-03-362	470.94
F-1	586-03-362	470.94
F-2	586-03-362	470.94
F-3	586-03-362	470.94
F-4	586-03-362	470.94
F-5	586-03-362	470.94
F-6	586-03-362	470.94
F-7	586-03-362	470.94
F-8	586-03-362	470.94
F-9	586-03-362	470.94
F-10	586-03-362	470.94
G-1	586-03-362	470.94
G-2	586-03-362	470.94
G-3	586-03-362	470.94
G-4	586-03-362	470.94
G-5	586-03-362	470.94
G-6	586-03-362	470.94
G-7	586-03-362	470.94
G-8	586-03-362	470.94
G-9	586-03-362	470.94
G-10	586-03-362	470.94
H-1	586-03-362	470.94
H-2	586-03-362	470.94
H-3	586-03-362	470.94
H-4	586-03-362	470.94
H-5	586-03-362	470.94
H-6	586-03-362	470.94
H-7	586-03-362	470.94
H-8	586-03-362	470.94
H-9	586-03-362	470.94
H-10	586-03-362	470.94
I-1	586-03-362	470.94
I-2	586-03-362	470.94
I-3	586-03-362	470.94
I-4	586-03-362	470.94
I-5	586-03-362	470.94
I-6	586-03-362	470.94
I-7	586-03-362	470.94
I-8	586-03-362	470.94
I-9	586-03-362	470.94
I-10	586-03-362	470.94
J-1	586-03-362	470.94
J-2	586-03-362	470.94
J-3	586-03-362	470.94
J-4	586-03-362	470.94
J-5	586-03-362	470.94
J-6	586-03-362	470.94
J-7	586-03-362	470.94
J-8	586-03-362	470.94
J-9	586-03-362	470.94
J-10	586-03-362	470.94
K-1	586-03-362	470.94
K-2	586-03-362	470.94
K-3	586-03-362	470.94
K-4	586-03-362	470.94
K-5	586-03-362	470.94
K-6	586-03-362	470.94
K-7	586-03-362	470.94
K-8	586-03-362	470.94
K-9	586-03-362	470.94
K-10	586-03-362	470.94
L-1	586-03-362	470.94
L-2	586-03-362	470.94
L-3	586-03-362	470.94
L-4	586-03-362	470.94
L-5	586-03-362	470.94
L-6	586-03-362	470.94
L-7	586-03-362	470.94
L-8	586-03-362	470.94
L-9	586-03-362	470.94
L-10	586-03-362	470.94
M-1	586-03-362	470.94
M-2	586-03-362	470.94
M-3	586-03-362	470.94
M-4	586-03-362	470.94
M-5	586-03-362	470.94
M-6	586-03-362	470.94
M-7	586-03-362	470.94
M-8	586-03-362	470.94
M-9	586-03-362	470.94
M-10	586-03-362	470.94

**SUMMIT PLACE
HORIZONTAL PROPERTY REGIME**

SCALE: 1" = 60'
DATE: OCTOBER 29, 1980



The undersigned certifies that the boundary for the property has been determined from a survey made by the undersigned on or about the date of the recording of this plan and that the boundary lines are correctly located and that the buildings and improvements are correctly located and that the boundary lines are correctly shown on the plan and that the boundary lines are correctly shown on the plan.

WESTMINSTER ENGINEERING CO., INC.
REGISTERED PROFESSIONAL ENGINEER
S.C. Registration No. 6571

NOTE:
THE AREA BETWEEN
THE EXISTING CURB AND
THE NEW CURB ARE
TO REMAIN UNDER
EXISTING MAINTENANCE
AND SHALL BE MAINTAINED
BY THE CITY OF
GREENVILLE.

PHASE	ACRES
PHASE I	1.58 ACRES
PHASE II	1.42 ACRES
PHASE III	1.48 ACRES
TOTAL ACERAGE	4.48 ACRES

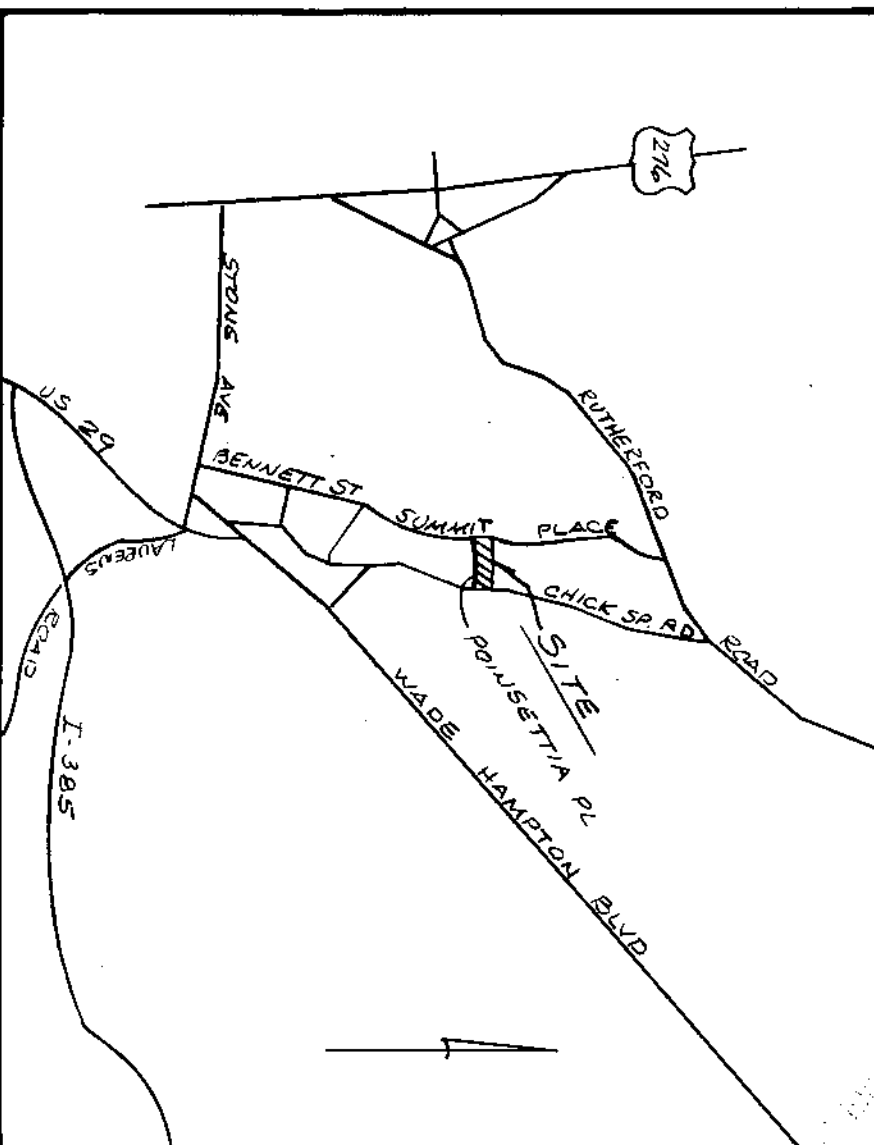

FINAL PLAT

CERTIFICATE OF OWNERSHIP AND DEDICATION
The undersigned hereby acknowledge that I am (we are) the owner(s) of the property shown and described herein and that I (we) hereby adopt this plan of subdivision with my (our) free consent and that I (we) establish the minimum building restriction lines, and hereby dedicate to public use the roads, streets, and easements, forever all areas so shown or indicated on said plat.

Signed: Westminster Co.
Signed: By: Howard D. Cooper, Jr.
Signed: District President

CERTIFICATE OF ACCURACY

I, **MITCHELL L. BAKER**, certify that this plat was (has been) drawn under my supervision from the information furnished to me by the owner(s) of the property shown and described herein, and that I (we) have compared the same with the original survey made by me) (have) description recorded in Book _____ Page _____ (date) (month) (year); that the amount of acres as calculated by me is 4.48 acres; that the total area of the land shown on this plat was prepared in accordance with the Surveying and Mapping Act of 1956, and that this plat was prepared in accordance with the Surveying and Mapping Regulations as adopted by the Board of Survey and Mapping.

DATE: OCTOBER 29, 1980
LICENSED PROFESSIONAL ENGINEER OR REGISTERED SURVEYOR
MITCHELL L. BAKER
S.C. Registration No. 6571

CERTIFICATE OF APPROVAL FOR RECORDING

I hereby certify that the subdivision plan shown herein has been found to comply with the Subdivision Regulations for Greenville County, with the exception of such variance, if any, as is noted in the minutes of the Greenville County Planning Commission of Greenville County, South Carolina, and that it has been approved for recording in the office of the County Register of Deeds Conveyance.

DATE: Nov. 4, 1980
Boyd S. Gales
DIRECTOR OF PLANNING
GREENVILLE COUNTY PLANNING COMMISSION

80-170
FILE NUMBER

AS-BUILT

SUMMIT PLACE
HORIZONTAL PROPERTY REGIME

WESTMINSTER COMPANY HEANER ENGR CO. INC.
GREENVILLE, S.C. GREENWOOD, S.C.
OWNER SURVEYOR

NO. OF ACRES: 4.48 MILES 0.125
NO. OF LOTS: DATE: 10-29-80



Plat filed this 5 day of Nov. to 80

And recorded in Va. 7-X, Page 55 at 3:28 PM

7-X-55
14221-A