

7-16-80  
 115'x15'

- NOTES:
- 1) ALL REFERENCE PINS ON CREEK ARE AT 10.0'
  - 2) THERE IS A 5' DRAINAGE AND UTILITIES EASEMENT EACH SIDE OF ALL SIDE AND REAR LOT LINES.
  - 3) ALL ADJACENT LOT NUMBERS REFER TO GREENVILLE COUNTY TAX BLOCK BOOK LOT NUMBERS
- TAX BLOCK BOOK NUMBER WG 81-1-32

Filed This day of Oct 1980  
 And Recorded in Vol. 79-162 of 115'x15'  
Donnie S. Jankensley  
 Registrar, Meigs & Son, Inc., Greenville County, S. C.

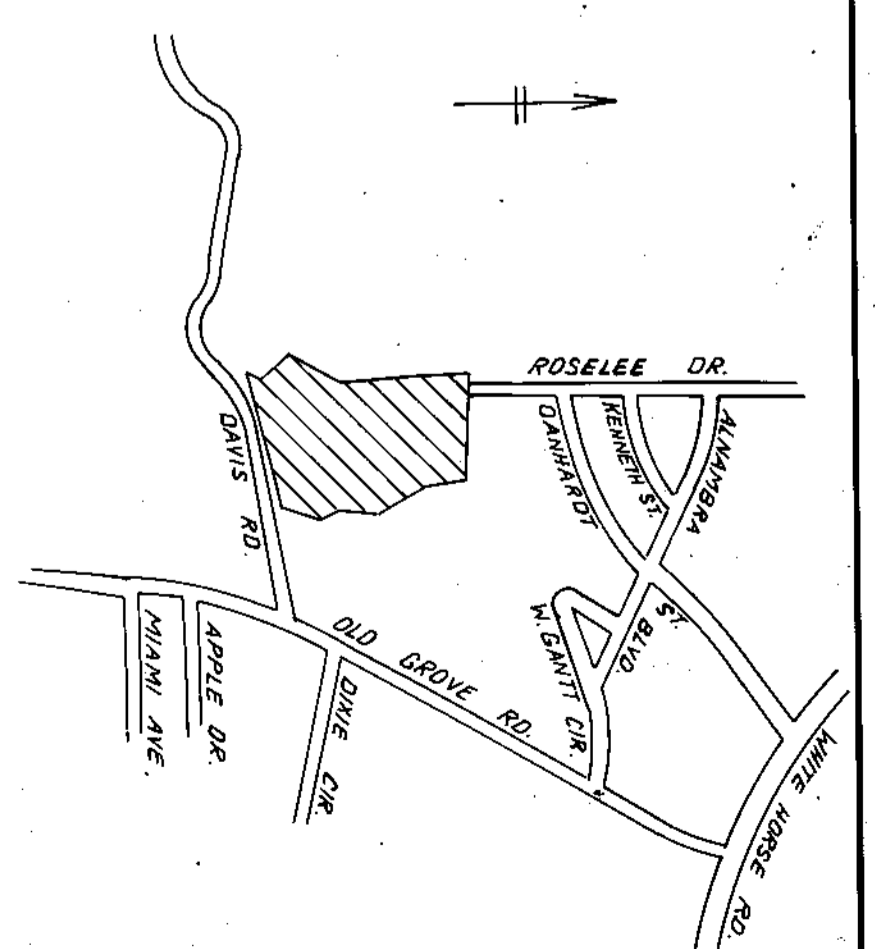
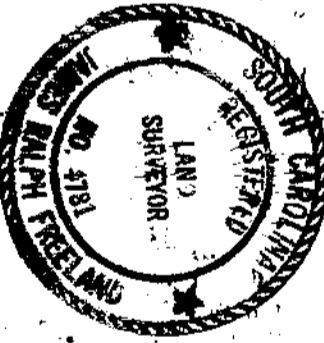

# FINAL PLAT

## CERTIFICATE OF OWNERSHIP AND DEDICATION

"The undersigned hereby acknowledge that I am (we and the owner(s) of the property shown and described herein and that I (we) hereby adopt this plan of subdivision with my (our) free consent and that I (we) establish the minimum building restriction lines, and hereby dedicate to public use as roads, streets, and easements, forever, all areas so shown or indicated on said plat.

7-16-80 Signed Donnie S. Jankensley  
 \_\_\_\_\_ Signed \_\_\_\_\_  
 \_\_\_\_\_ Signed \_\_\_\_\_  
 \_\_\_\_\_ Signed \_\_\_\_\_

## CERTIFICATE OF ACCURACY

"I, JAMES R. FREELAND, certify that this plat was (shown-by-me) (shown under my supervision) (an actual survey made under my supervision) from (on-stake-survey made-by-me) (land description recorded in Book \_\_\_\_\_ Page \_\_\_\_\_ of \_\_\_\_\_ (other): that the error of closure as calculated by \_\_\_\_\_ (other): that the boundaries not surveyed are shown as broken lines plotted from information found in Book \_\_\_\_\_ Page \_\_\_\_\_ that this plat was prepared in accordance with the Greenville County Subdivision Regulations as adopted.

DATE \_\_\_\_\_  
 \_\_\_\_\_ LICENSED ENGINEER OR REGISTERED SURVEYOR  
 S. C. Registration No. 4781

## CERTIFICATE OF APPROVAL FOR RECORDING

"I hereby certify that the subdivision plat shown hereon has been found to comply with the Subdivision Regulations for Greenville County, with the exception of such variances, if any, as are noted in the minutes of the Greenville County Planning Commission of Greenville County, South Carolina, and that it has been approved for recording in the office of the County Register of Meigs & Son, Inc., Greenville County, South Carolina.  
 DATE Oct 2 1980  
 \_\_\_\_\_  
 DIRECTOR OF PLANNING  
 GREENVILLE COUNTY PLANNING COMMISSION

FILE NUMBER  
**79-162**

CROOKED CREEK  
 SHEET 2

SUNBELT PROPERTIES  
 OWNER  
 FREELAND & ASSOC.  
 SURVEYOR

NO. OF ACRES: 14.4 MILES OF NEW ROAD: 0.4

NO. OF LOTS: 55 DATE: 7-16-80

