

MICROFILMED

FILED
GREENVILLE CO. S.C.

MAR 6 3:05 PM '80

DONNIE S. TANKER
R.M.C.

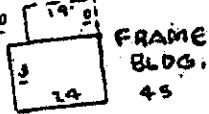

PROPERTY OF
WILLIAM RALPH STONE
KATHERINE S. STONE
NEAR GREENVILLE, S.C.
SCALE: 1" = 40' 29 FEB 1980

- 121 - - 120 - - 119 -

N 59-34 E
288.0

381.4
S 55-09 W

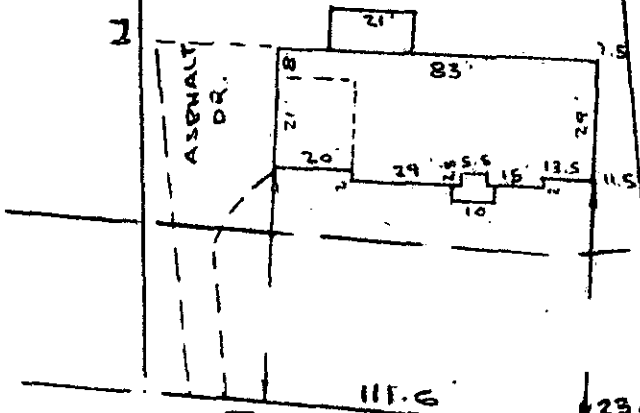

45 B.L.

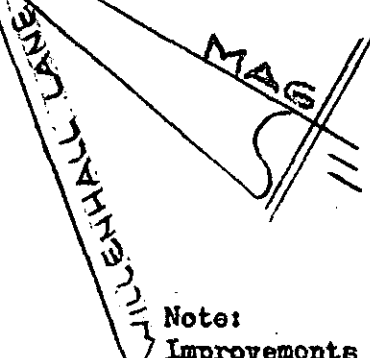

Note:
Improvements on this lot are not in a flood hazard area.

26660

MAR 6 1980

7-W-2

ELMHURST ROAD
WATER & SEWER IN RD. R/W

This is to certify that on the 29th day of February, 1980, I surveyed the property shown on this plat, being known as lot 120 on plat of WESTCLIFFE and recorded in the RMC Office Greenville County, S. C., in Plat Book " Y Y " at Pages 168 & 169; and that the property lines, walls and buildings are as shown hereon, and that the walls and buildings located on said lot do not encroach or project on adjacent street or property, and that no adjacent walls or buildings encroach or project on said premises, and no power lines cross this property except as shown hereon.

[Handwritten signature]

CAROLINA SURVEYING CO.
112 Manly St., Greenville, S. C.

[Handwritten signature]
R. E. Bruce, RLS 1952

SCTO --- 1 MR 6 80 1547 3-0061