

VIEW POINT DRIVE
WATER IN ST. RAN

N 60.00 E

591.2 ±
MICROFILMED

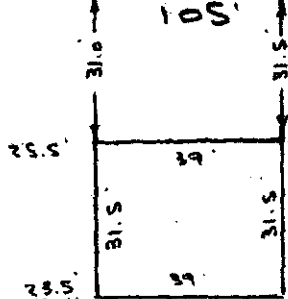

- SEPTIC TANK ON LOT -

- 0.62 AC. -

PROPERTY OF
HARRY JOSEPH SWAIM
JUDY CAROL SWAIM
NEAR GREENVILLE, S.C.
SCALE: 1"=40' 25 FEB 1980

FILED
GREENVILLE CO. S.C.
FEB 27 10 35 AM '80
DONNIE S. TANKERSLEY
R.M.C.

- PT. TRACT 13 -

VIRGINIA SUMMEY

WILLIAM S. GILLIAM

DEBORAH ANN YAMM



GCTO --- 1 FEB 27 80 810 3.00CI

26.3
584-16W
78.7
541-56W

- MICHAEL BROWN -

- PT. TRACT 13 -

25820 ✓

7-V-76

FEB 27 1980

This is to certify that on the 25th day of February, 1980, I surveyed the property shown on this plat, being known as 0.62 acre on MAP OF CLAIREMONT RIDGE and recorded in the RMC Office Greenville County, S. C., in Plat Book " H " at Page 182 and also being known as PROPERTY OF HARRY JOSEPH SWAIM & JUDY CAROL SWAIM and recorded in Plat Book at Page ; and that the property lines, walls and buildings are as shown hereon, and that the walls and buildings located on said lot do not encroach or project on adjacent street or property, and that no adjacent walls or buildings encroach or project on said premises, and no power lines cross this property except as shown hereon.

[Signature]
CAROLINA SURVEYING CO.
112 Manly St., Greenville, S. C.
[Signature]
R. B. Bruce, RLS #1952