

MICROFILMED

JACKS

358.7'

S 83° 04' W

S 37° 19' E

2.33 ACRES

275.0 TOTAL

TIMMONS

EVANS

BLOCK BLDG.

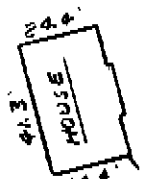

REF. I.R.C. 2007

1364.3 TO S.C. HWY 20

117.7'

74.5'

127.0'

REF. I.R.C. 20.0

OSTEEN ROAD

N 74° 55' E

N 77° 57' E

N 79° 33' E

S 89° 48' E

MOORE

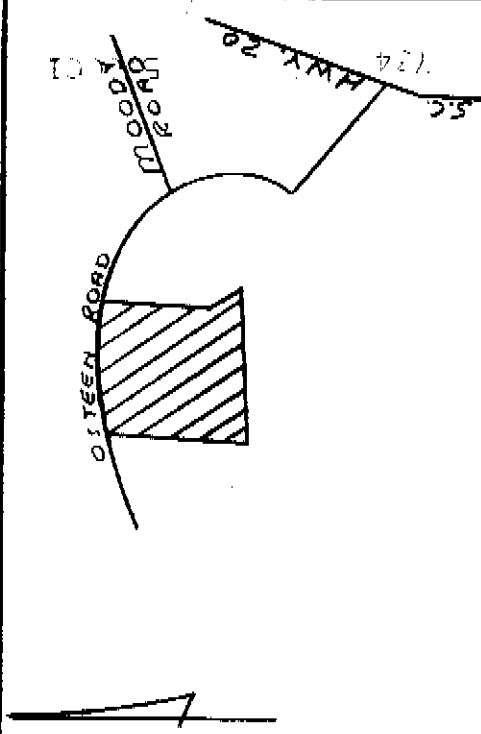

LOCATION MAP (N.T.S.)

FILED
GREENVILLE CO. S. C.
APR 30 3 22 PM '80
DONNIE S. TARKERSLEY
R.H.C.

APR 30 1980

31919

7-6-85

This is to certify that on April 25, 1980, I surveyed the property shown on this plat, known as Property of Jan D. Green, recorded in the RMC Office of Greenville County in Deed Book 869 on page 546, and that the property lines, walls and buildings are as shown hereon; that the building located on said property does not encroach or project on adjacent streets or property, and that no adjacent walls or buildings encroach or project on said premises, and that no utility lines cross this property except as shown hereon. This property is not located in a designated flood hazard area.

James R. Freeland
James R. Freeland RLS & PE #781

6152-1-9

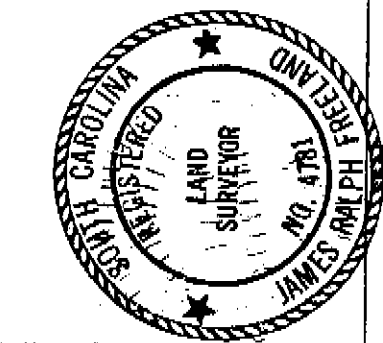

STATE OF SOUTH CAROLINA
GREENVILLE COUNTY
PROPERTY OF
ANDREW S. THURSTON
AGATHA M. THURSTON

FREELAND & ASSOCIATES
Engineers - Land Surveyors
GREENVILLE, S.C.
SURVEY L.T.
DRAWN M.C.
CHECK M.C.
SCALE 1" = 60'
DATE 4-25-80
DWG. NO. 80-5004