

UNDERGROUND

UTILITIES

MICROFILMED

96

578°-47'E 100.0'



201.2' 87

1970'

93

92

511°-13'W 86

N 11°-11'E

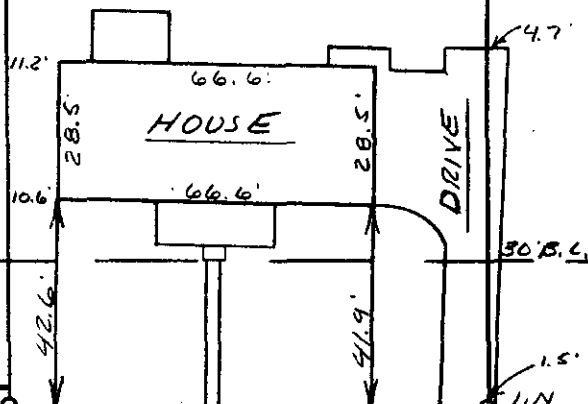

This is to certify that on November 19, 1979, I surveyed the property shown on this plat, known as Lot 92 on plat of Forrester Woods Sec. 2, recorded in the RMC Office of Greenville County in Plat Book 4X on page 64, and that the property lines, walls and buildings are as shown hereon; that the building located on said lot does not encroach or project on adjacent streets or property, and that no adjacent walls or buildings encroach or project on said premises, and that no utility lines cross this property except as shown hereon. This property is not located in a designated flood hazard area.

James R. Freeland
James R. Freeland RLS & PE 4781

176'± TO OVER CREEK RD

N 76°-24'W 100.0'

CREEKWOOD COURT

FILED
GREENVILLE CO. S.C.
Nov 19 2 53 PM '79
DONNIE S. TANKERSLEY
R.M.C.

7-5-20

17910

NOV 19 1979

M 9.1-1-112



STATE OF SOUTH CAROLINA
GREENVILLE COUNTY

FORRESTER WOODS
SEC. 2 - LOT 92
PROPERTY OF
RON F. LEVIN

FREELAND & ASSOCIATES
Engineers • Land Surveyors

GREENVILLE, S.C.

SURVEY	D.C.H.
DRAWN	M.C.
CHECK	MC
SCALE	1" = 40'
DATE	11-19-79
DWG. NO.	79-4430

SEAL

3.00CI