

MAGNETIC NORTH

FILED
GREENVILLE CO. S.C.
FEB 27 10 20 AM '80
DONNIE TANKERSLEY
R.M.C.

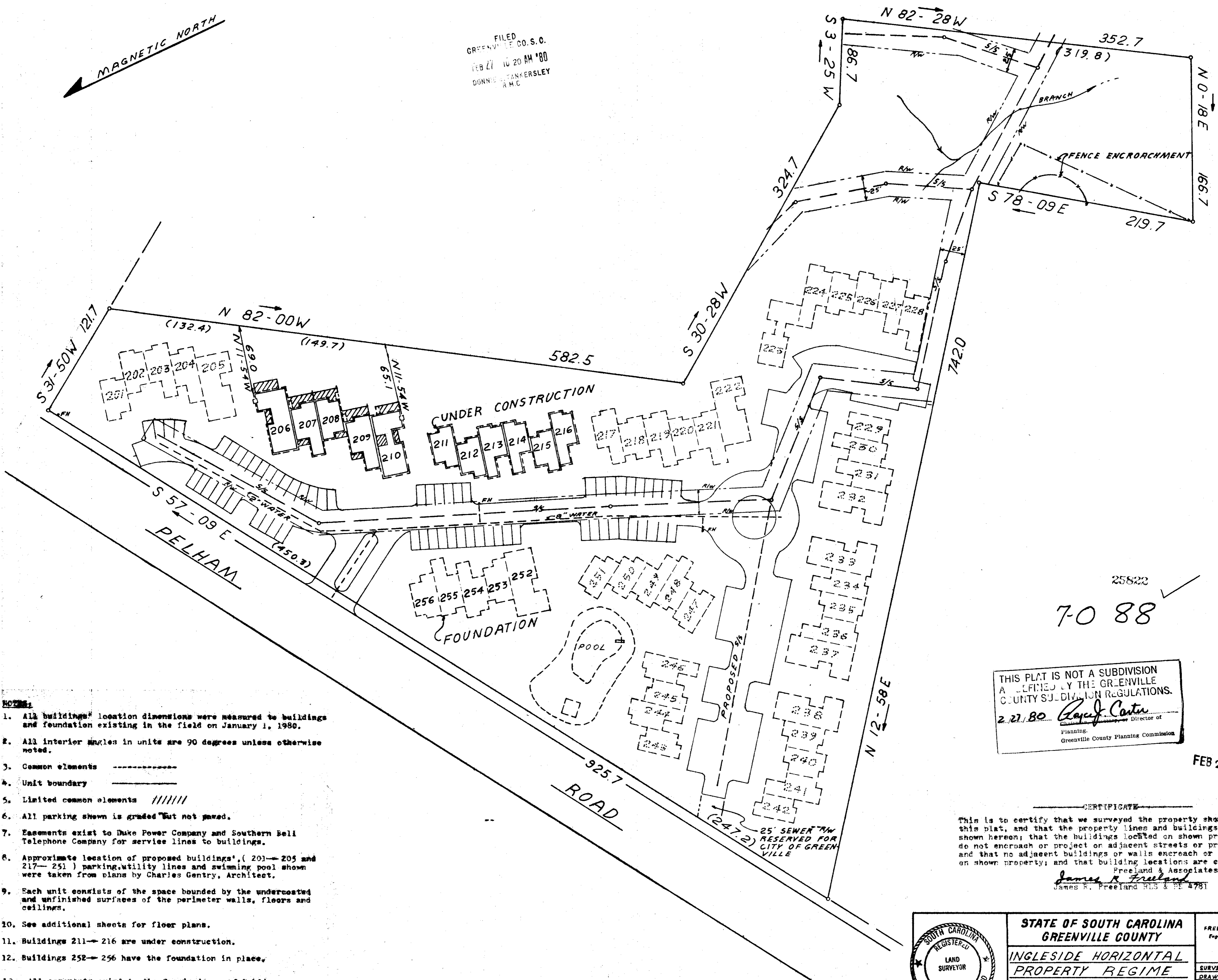

- NOTES:**
1. All buildings' location dimensions were measured to buildings and foundation existing in the field on January 1, 1980.
 2. All interior angles in units are 90 degrees unless otherwise noted.
 3. Common elements -----
 4. Unit boundary _____
 5. Limited common elements // // // //
 6. All parking shown is graded but not paved.
 7. Easements exist to Duke Power Company and Southern Bell Telephone Company for service lines to buildings.
 8. Approximate location of proposed buildings*, (201-205 and 217-251) parking, utility lines and swimming pool shown were taken from plans by Charles Gentry, Architect.
 9. Each unit consists of the space bounded by the undercoated and unfinished surfaces of the perimeter walls, floors and ceilings.
 10. See additional sheets for floor plans.
 11. Buildings 211-216 are under construction.
 12. Buildings 252-256 have the foundation in place.
 13. All easements exist to the Commissioner of Public Works of the City of Greenville, S.C. for water lines.

25822
7-0 88

THIS PLAT IS NOT A SUBDIVISION
AS DEFINED BY THE GREENVILLE
COUNTY SUBDIVISION REGULATIONS.
2/27/80 *Ray C. Carter* Director of
Planning
Greenville County Planning Commission

FEB 27 1980

CERTIFICATE
This is to certify that we surveyed the property shown on this plat, and that the property lines and buildings are as shown hereon; that the buildings located on shown property do not encroach or project on adjacent streets or property, and that no adjacent buildings or walls encroach or project on shown property; and that building locations are correct.
James R. Freeland
James R. Freeland H.L.S. & P.E. 4781



STATE OF SOUTH CAROLINA GREENVILLE COUNTY		FREELAND & ASSOCIATES Engineers - Land Surveyors GREENVILLE, S.C.
INGLESIDE HORIZONTAL PROPERTY REGIME		SURVEY V 8
		DRAWN JRF
		CHECK
		SCALE 1" = 50'
		DATE 2-5-80
		DWG. NO.

SCTD -- 1 FEB 78 80 804 5.0001