

MICROFILMED

FILED
GREENVILLE CO. S.C.

JUL 31 3 31 PM '79
DONNIE S. TANKERSLEY
R.M.C.

EDWARDS ROAD

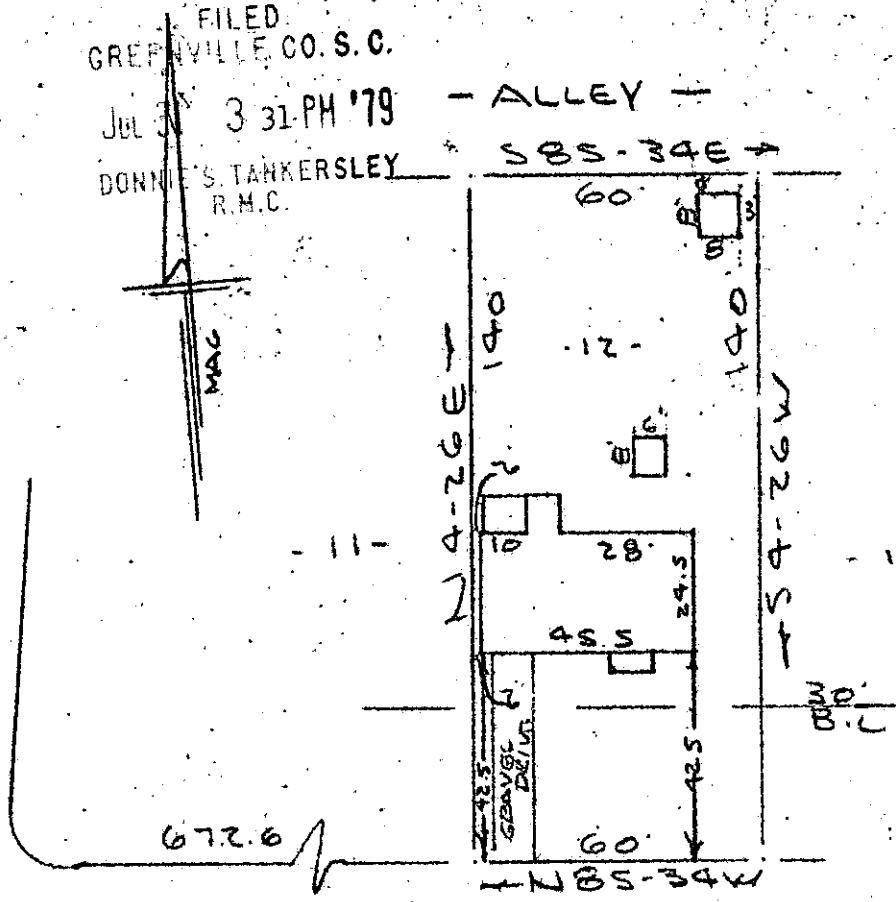

NOTE: Improvements on this lot are not in a flood hazard area.

MORRIS STREET
WATER & SEWER IN ST RW

PROPERTY OF
DOUGLAS A BYARS & JEANNETTE A. BYARS
GREENVILLE, S.C.
SCALE 1" = 40' 16 JULY 1979

This is to certify that on the 16th day of July, 1979, I surveyed the property shown on this plat, being known as lot 12 on plat of PROPERTY OF LESLIE & SHAW INC. and recorded in the RMC Office Greenville County, S. C., in Plat Book "NW" at Page 3; and that the property lines, walls and buildings are as shown hereon, and that the walls and buildings located on said lot do not encroach or project on adjacent street or property, and that no adjacent walls or buildings encroach or project on said premises, and no power lines cross this property except as shown hereon.

7-K-19 ✓

R. B. Bruce

R. B. Bruce, R.S. 1952

3728

CAROLINA SURVEYING CO.
112 Manly St.
Greenville, S. C.



GCTG -----2 JUL 31 79 1539