

REEDY RIVER IS LINE

N14-22W

N15-33W

POWER 137.9

TRAVELER LINE J

225

FILED
GREENVILLE CO S.C.
JUN 6 11 42 AM '79
DONNIE S. FANKERSLEY
R.M.C.

169.7

3/4" DIA SAN SEWER

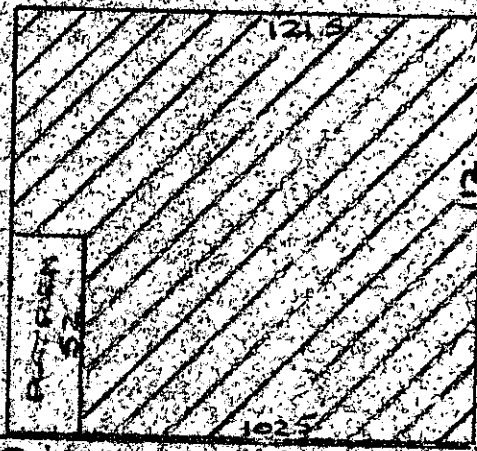

15918
GREENVILLE & NORTHHEAL RR CO
SULPHUR SPRINGS ROAD

137.2

225

SIG 40E
SAUR

362.2 TOT
GEN RE
MAIL LINE

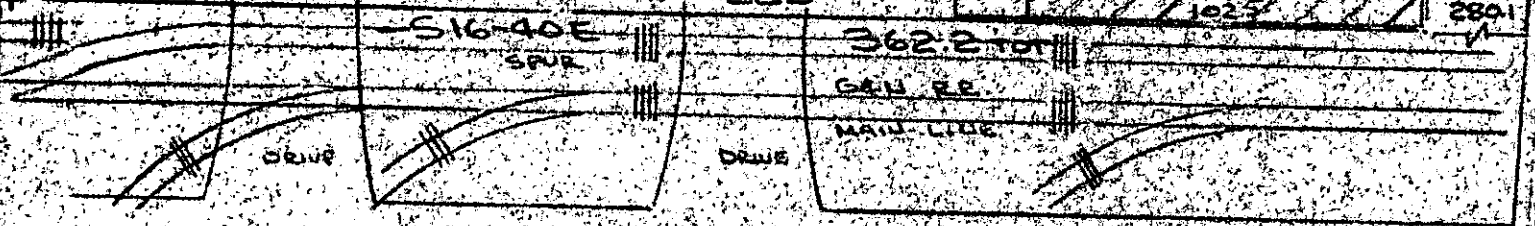

PINSLY CIRCLE
WATER IN ST RW

PROPERTY OF
AMERICAN METAL & MACHINE WORKS, INC
NEAR GREENVILLE, S.C.
SCALE 1"=50' 2 APRIL 1979

This is to certify that on the 2nd day of April, 1979, I surveyed the property shown on this plat, being known as PROPERTY OF AMERICAN METAL & MACHINE WORKS, INC, and recorded in the RMC Office Greenville County, S. C., in Plat Book " " at Page ; and that the property lines, walls and buildings are as shown hereon, and that the walls and buildings located on said lot do not encroach or project on adjacent street or property, and that no adjacent walls or buildings encroach or project on said premises, and no power lines cross this property except as shown hereon.

7-8-10

R. B. Bruce
R. B. Bruce, RLS 1952

692



JUL 6 1979

CAROLINA SURVEYING CO.
112 Manly St.
Greenville, S.C.

1.00CI