

(WASHINGTON PLACE)

EAST MCBEE AVENUE

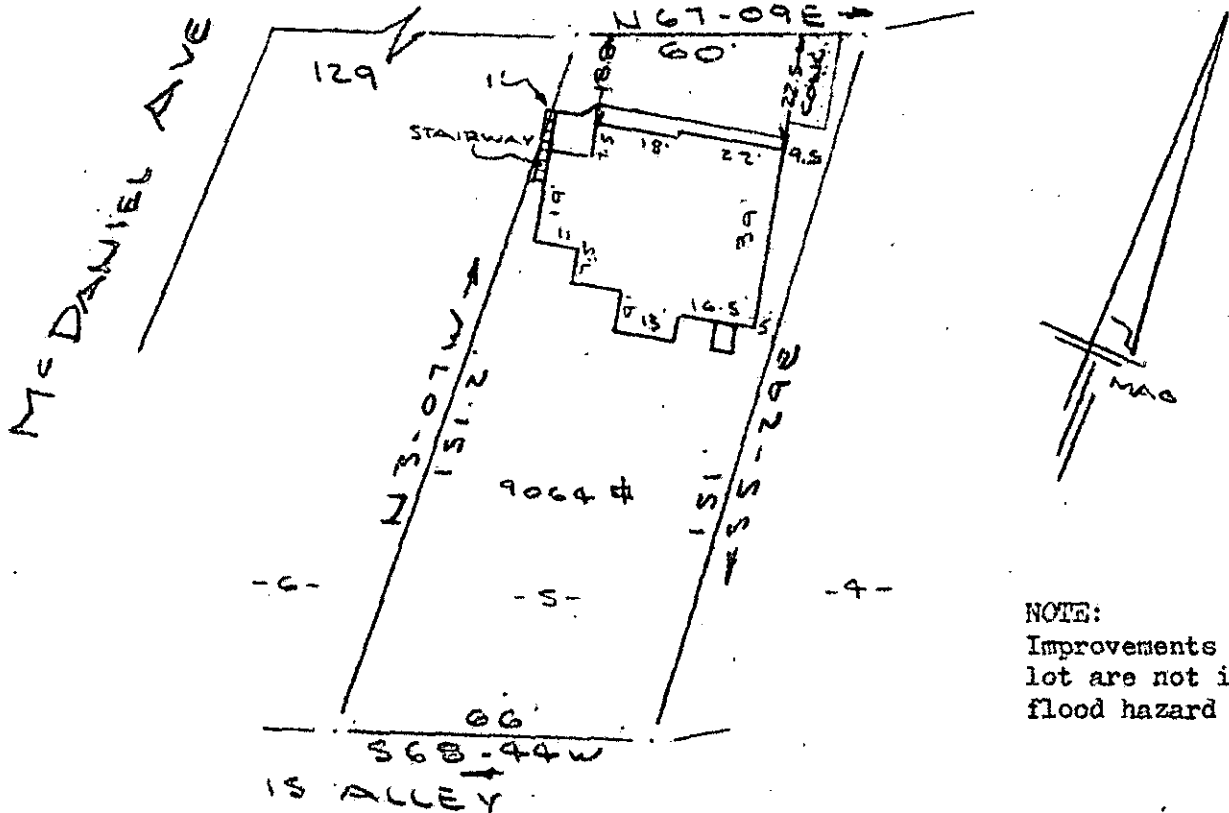

NOTE:  
 Improvements on this  
 lot are not in a  
 flood hazard area.

PROPERTY OF  
**JUANITA S. MACKAY**  
 NEAR GREENVILLE, S.C.  
 SCALE: 1" = 40' 13 JUNE 1979

This is to certify that on the 13th day of June, 1979, I surveyed the property shown on this plat, being known as lot 5 on plat of J. W. NORWOOD PROPERTY and recorded in the REC Office Greenville County, S. C., in Plat Book " E " at Page 283; and that the property lines, walls and buildings are as shown hereon, and that the walls and buildings located on said lot do not encroach or project on adjacent street or property, and that no adjacent walls or buildings encroach or project on said premises, and no power lines cross this property except as shown hereon.

FILED  
 GREENVILLE CO. S. C.  
 JUN 21 3 54 PM '79  
 DONNIE S. TANKERSLEY  
 R.M.C.

*R. B. Bruce*  
 R. B. Bruce, DIS 1952  
 JUN 21 1979

37969

CAROLINA SURVEYING CO.  
 112 Manly St.  
 Greenville, S. C.

7-H-44