

FILED  
GREENVILLE CO. S. C.  
MAR 1 10 52 AM '73  
DONNIE S. TAMMER

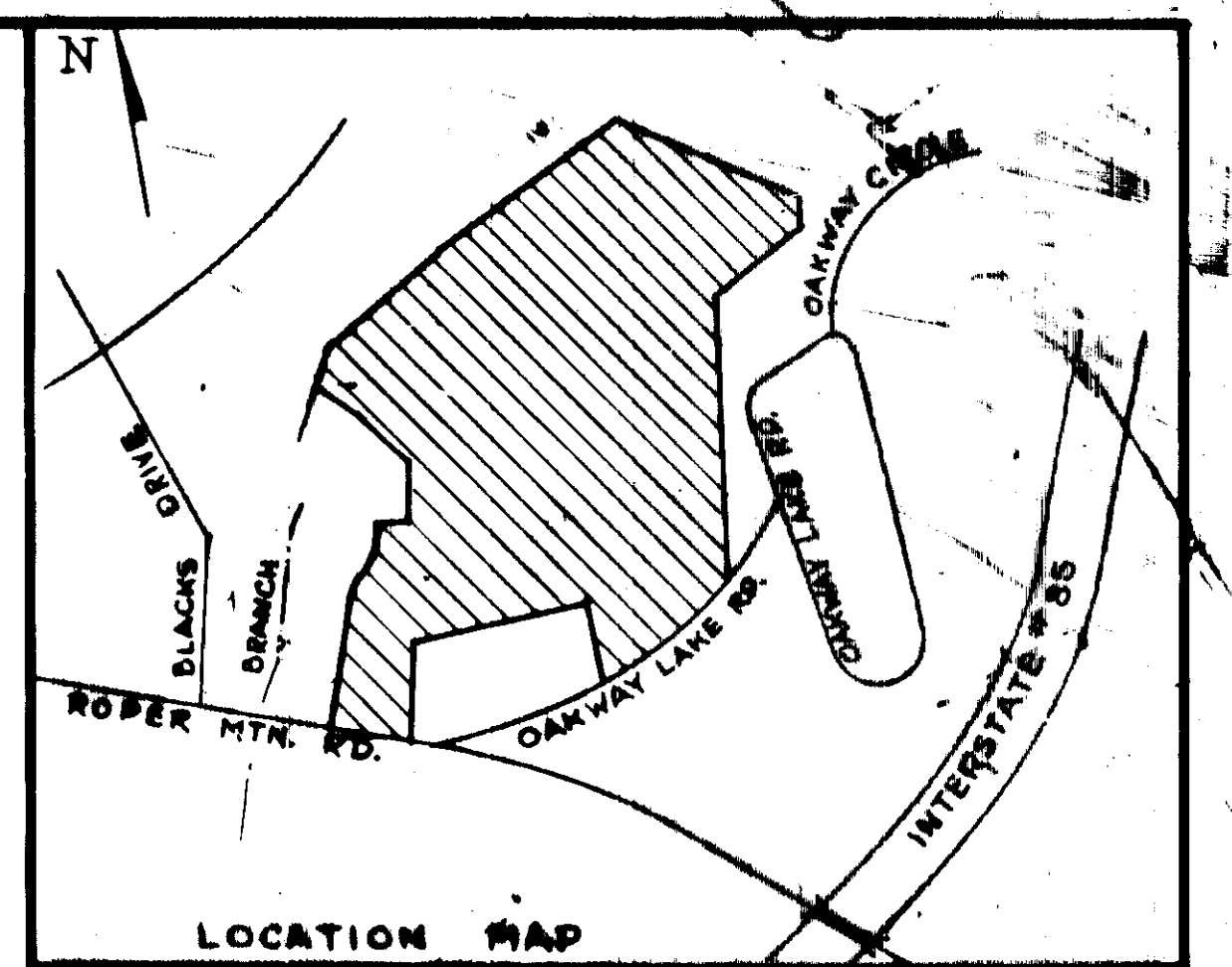

DECLARATION OF JUNE 22ND AND DEDICATION  
I, the undersigned, do hereby certify that I am (we are) the owner (owners) of the land described herein and that the same is being dedicated to the public use of the community for all areas shown on this plat. My (our) signature (signatures) is given for all areas shown on this plat.  
9-2-72  
[Signature]  
[Signature]

CERTIFICATE OF ACCURACY  
I, the undersigned, do hereby certify that this plat was prepared by me (us) under the supervision of the actual surveyor (surveyors) named herein and that the same is a true and correct copy of the original survey as shown on the original survey map. My (our) signature (signatures) is given for all areas shown on this plat.  
9-2-72  
[Signature]  
[Signature]

PLAT OF APPROVAL FOR RECORDING  
I, the undersigned, do hereby certify that this plat was prepared by me (us) under the supervision of the actual surveyor (surveyors) named herein and that the same is a true and correct copy of the original survey as shown on the original survey map. My (our) signature (signatures) is given for all areas shown on this plat.  
10-12-72  
[Signature]

REVISED  
3/1/79  
DATE

PERFORMANCE BOND POSTED  
FOR RECORDING APPROVAL  
FILE NUMBER 71-160

COMPILED PLAT OF  
LOT LINE CHANGES BY  
FREELAND & ASSOC.  
2-22-79  
REVISED LOTS  
148 167  
149 168  
157 117

REVISED  
3/1/79  
DATE

SEE SHEET NO. 1 & 2  
FOR LEGEND & NOTES

SHEET NO. 3 OF 3	
DOVE TREE	
THOMAS J. FREELAND, ET AL OWNER	FREEMONT ENGINEERS & ARCHITECTS SURVEYOR
NO. OF ACRES 108.5	MILES OF NEW ROADS 2.22
NO. OF LOTS 171	DATE 5-11-72 REV. 9-2-72
ERROR OF CLOSURE 17.3820	
SCALE 1" = 100'	

Plat filed This 1st day of March 1979  
And Recorded in Vol. 7-C Page 1 at 10:51 A.M.  
Donnie S. Tammer  
Register of Deeds, Greenville County, S. C.

7-C-1  
#25014

PLAT # 20