

CRESTONE DRIVE (KING STREET)

WATER & SEWER IN ST AIR

S 46-34E

10 BUILDING
LINE

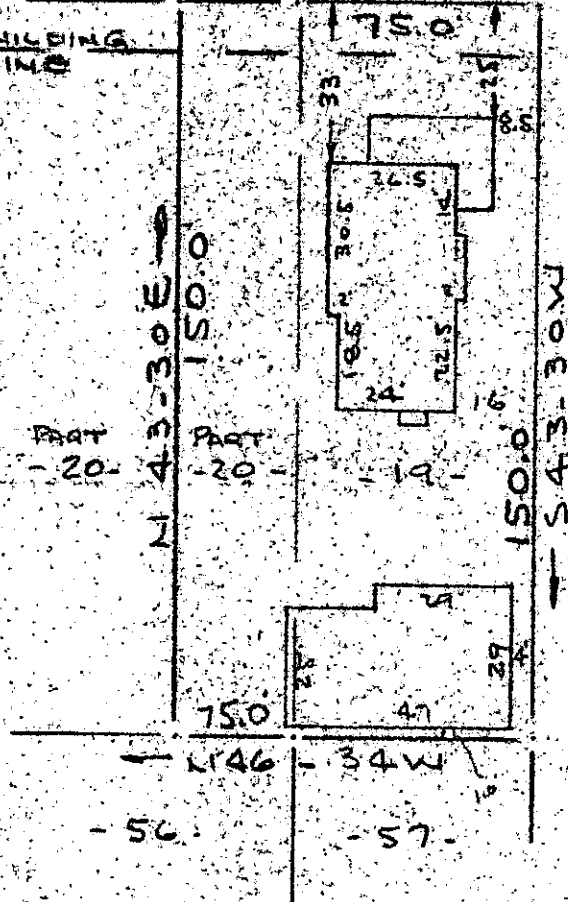

VALLEY STREET

NOTE: Improvements on this lot are not in a flood hazard area.

PROPERTY OF
VERNON D. MOON & CLARA JEAN MOON
NEAR GREENVILLE, S.C.
SCALE 1" = 40' 21 MARCH 1979

This is to certify that on the 21st day of March, 1979, I surveyed the property shown on this plat, being known as lot 19 and part of lot 20 on plat of WESTVIEW HEIGHTS and recorded in the RMC Office Greenville County, S. C., in Plat Book "G" at Page 33; and that the property lines, walls and buildings are as shown hereon, and that the walls and buildings located on said lot do not encroach or project on adjacent street or property, and that no adjacent walls or buildings encroach or project on said premises, and no power lines cross this property except as shown hereon.

R. B. Bruce
R. B. Bruce, RLS #1952

27690

CAROLINA SURVEYING CO.
112 Manly St.
Greenville, S. C.

MAR 27 1979

GCTO ----- 2 MR 27 79 787

1.00CI

FILED
GREENVILLE CO. S.C.
MAR 27 3 55 PM '79
DONNIE S. TANKERSLEY
R.H.C.

7-B-95

220 @ 52A

226.9-5