

LOONEYBROOK DRIVE

WATER & SEWER IN ST. ALW.  
524.00E

FILED  
GREENVILLE CO. S. C.  
DEC 21 2 51 PM '78  
BONNIE S. TAKKERSLEY  
R.M.C.

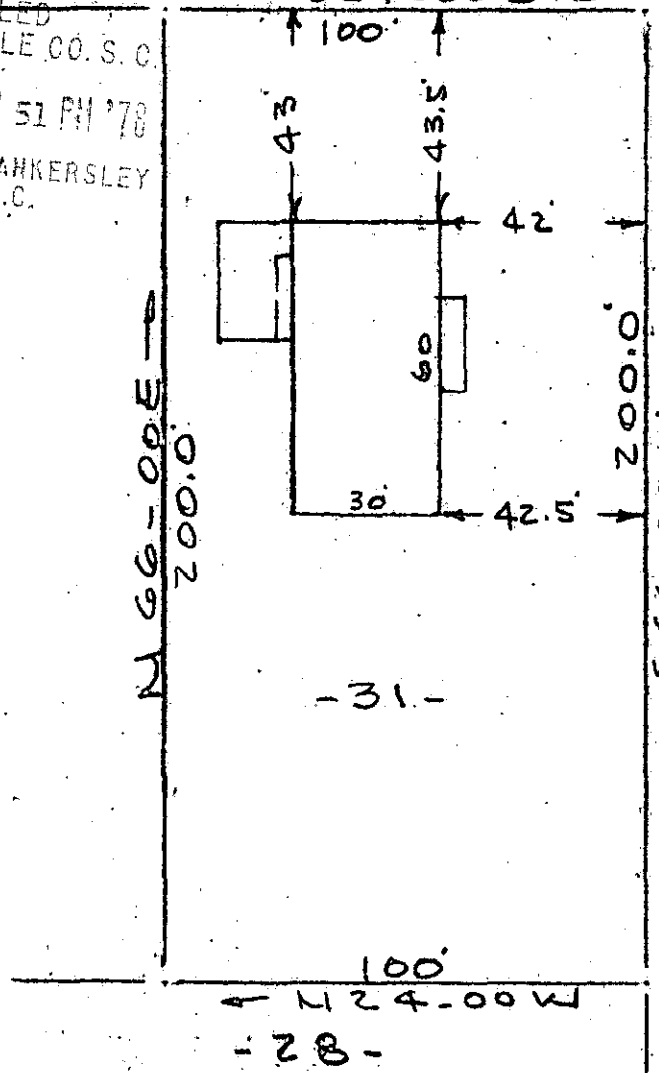

ALICE STREET

NOTE: Improvements on this lot are not in a flood hazard area.

-30-

-31-

100'  
← 524.00W  
-28-

PROPERTY OF  
JAMES R. BAILEY & INA LOU BAILEY  
GREENVILLE COUNTY FOUNTAIN INN, S.C.  
SCALE 1" = 40' 18 DEC 1978

This is to certify that on the 18th day of December, 1978, I surveyed the property shown on this plat, being known as lot 31 on plat of SUNSET HEIGHTS and recorded in the R.M.C. Office Greenville County, S. C., in Plat Book " 00 " at Page 314; and that the property lines, walls and buildings are as shown hereon, and that the walls and buildings located on said lot do not encroach or project on adjacent street or property, and that no adjacent walls or buildings encroach project on said premises, and no power lines cross this property except as shown hereon.

✓ 16-Y-28 18890

R. B. Bruce  
CAROLINA SURVEYING CO.  
112 Hanly St., Greenville, S.C.

GCTO) --- 1 DEC 21 78 1537

1.0001

CAROLINA SURVEYING CO.  
112 Hanly St., Greenville, S.C.