

FILED
GREENVILLE CO. S. C.

MAR 9 3 12 PM '79

DONNIE S. TANKERSLEY
R.M.C.

THIRD FLOOR McDANIEL HEIGHTS HORIZONTAL PROPERTY REGIME

GREENVILLE COUNTY
GREENVILLE, SOUTH CAROLINA

Scale 1"=20' January, 1979

DALTON & NEVES CO. ENGINEERS

121 MANLY STREET

GREENVILLE, S. C.

LEGEND

1. This plan shows location of Buildings 1 through 5 containing a total of 62 units. Also shown are two garage buildings being Limited Common Elements, together with spaces provided for parking.
2. The additional sheets of this Exhibit B show typical floor plans for the units, their location in each building, and typical front building elevations.
3. Each unit consists of the space bounded by the undercoated and/or unfinished surfaces of the perimeter walls, floors and ceiling.
4. All interior angles in units are 90° unless otherwise noted.
5. Common Elements: ————
6. General Common Area: ————

The undersigned certifies that the boundary for the property was drawn from an actual survey dated January, 1979 made by me and that the courses and distances are true and correct, that the building and improvements located thereon are accurately located, that the building and improvements do not encroach or project over the boundary lines.

Donnie S. Tankersley
S.C. Reg. No. 916

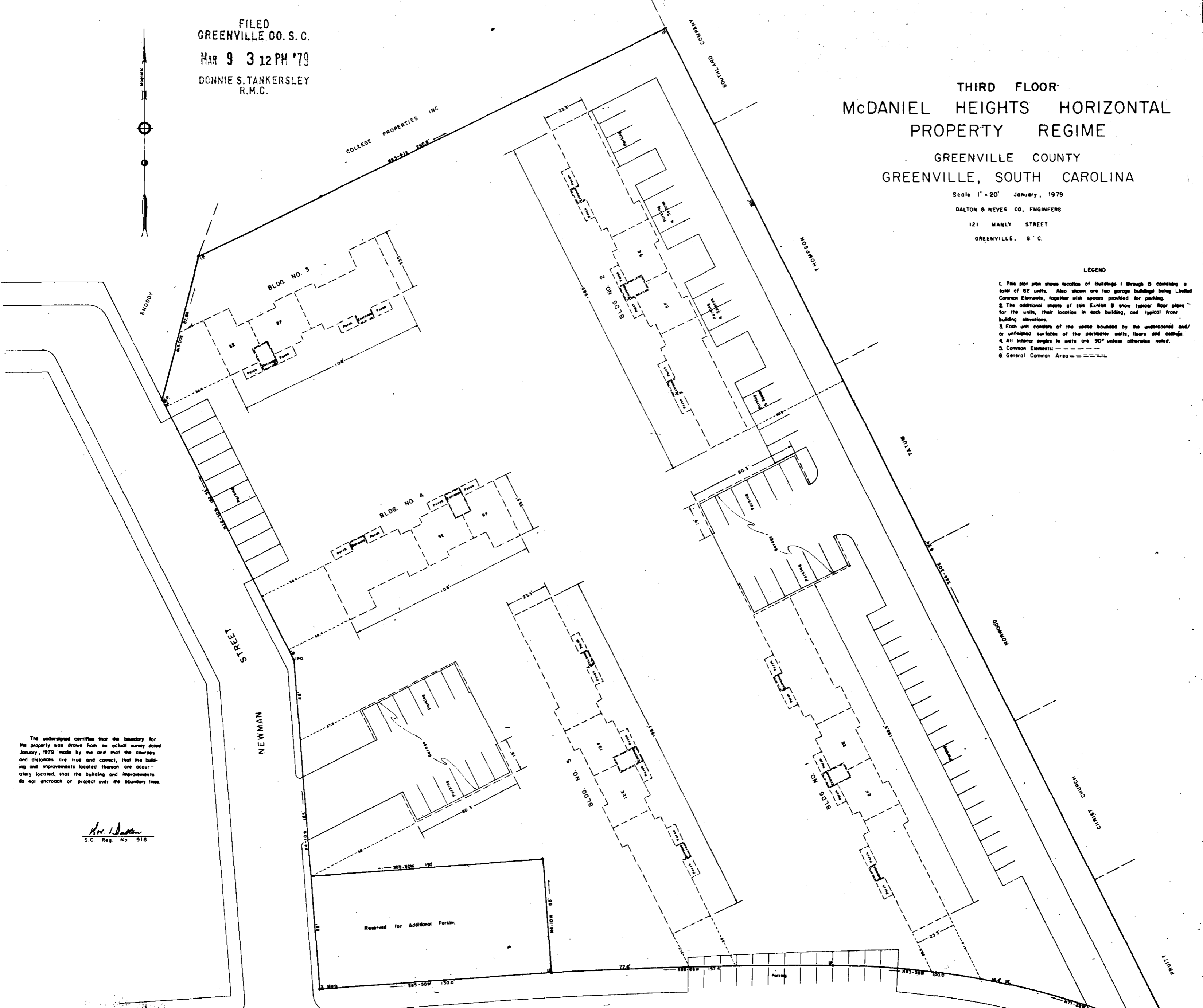

25882-54

25882

THIS PLAT IS NOT A SUBDIVISION
AS DEFINED BY THE GREENVILLE
COUNTY SUBDIVISION REGULATIONS.
3/9/79 *Ray J. Carter*
Chairman, or Director of
Planning,
Greenville County Planning Commission

GCTO ----- 3 MR. 9 79 056

3.00 CI
AREA = 4.18 Acres

MICROFILMED

GCTO ----- 3 MR. 9 79 055