

-288-

-289-

N 52-12 E

10' DRAIN EASE

DITCH
10' DRAIN EASE

IMPERIAL DR.

-232-

-233-

-234-

N 37-48 W
175'

175'
S 37-48 E

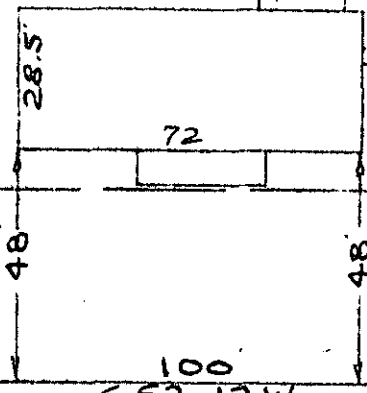

40
B.C.

NOTE: Improvements on this lot are not in a flood hazard area.

198.8

100
S 52-12 W

ROLLINGGREEN RD.
WATER & SEWER IN ST. R/W

PROPERTY OF
ROGER N. WESLEY
NEAR GREENVILLE, S.C.
SCALE: 1"=40' 21 JULY 1977

FILED
GREENVILLE, CO. S. C.
JUL 27 10 47 AM '77
EDONNIE S. TANKERSLEY
R.M.C.

This is to certify that on the 21st day of July, 1977, I surveyed the property shown on this plat, being known as lot 233 on plat of SECTOR V BOTANY WOODS and recorded in the REC Office Greenville County, S. C., in Plat Book "YY" at Pages 6 & 7; and that the property lines, walls and buildings are as shown hereon, and that the walls and buildings located on said lot do not encroach or project on adjacent street or property, and that no adjacent walls or buildings encroach or project on said premises, and no power lines cross this property except as shown hereon.

R. B. Bruce

R. B. Bruce, RLS #1952

6G-4

CAROLINA SURVEYING CO.
112 Manly St.
Greenville, S. C.

2876

MICROFILMED