

FILED

GREENVILLE CO. S. C.

APR 28 2 40 PM '77

DONNIE S. TANKERSLEY  
R.M.C.

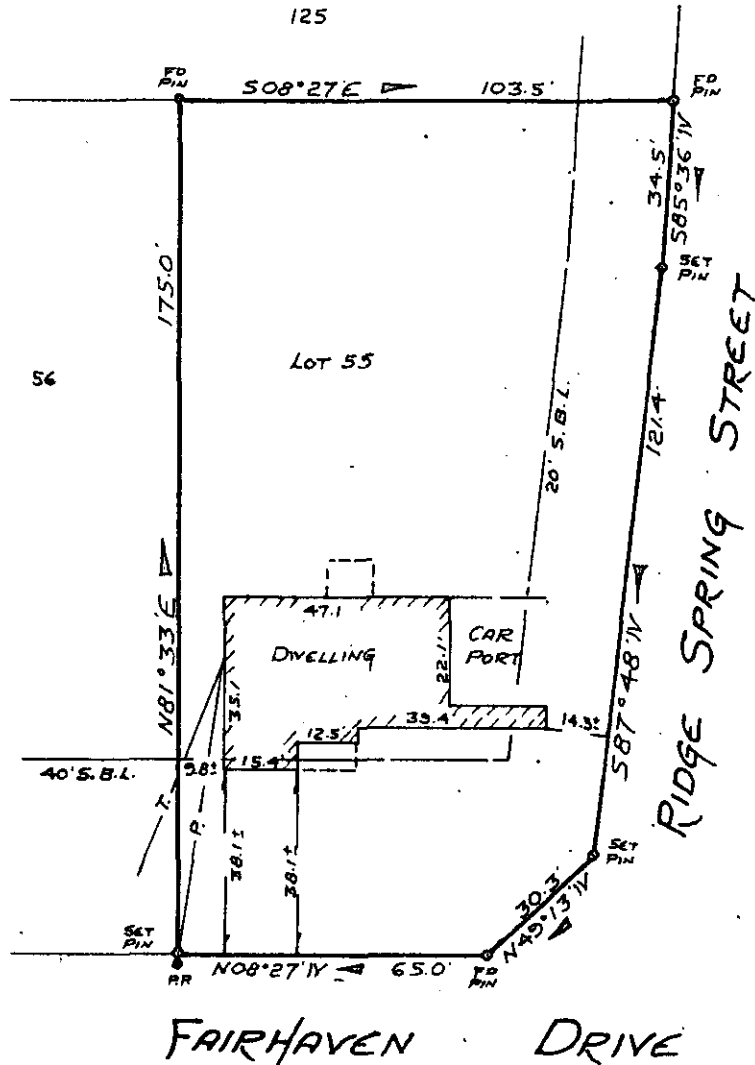

NOTE:  
THERE IS A 5' EASEMENT FOR  
DRAINAGE AND UTILITIES ON EACH  
SIDE OF ALL SIDE AND REAR LOT  
LINES.

PROPERTY OF  
GLENNON G. ADAMS

'NEAR GREENVILLE, SOUTH CAROLINA  
SCALE 1"=40' APRIL 19, 1977

This is to certify that on April 19, 1977, I surveyed the property shown on this plat, known as Lot No. 55 of Section II of Orchard Acres as shown on a plat recorded in the RMC Office for Greenville Co., in Plat Book QQ, page 6, and that the property lines, walls and building are as shown hereon, and that the building located on said lot does not project nor encroach on adjacent streets or property, and that no adjacent walls or buildings project nor encroach on this lot, and that no utility lines cross this lot except as may be shown hereon.

NOTE: This property is not  
located within a flood  
hazard area.

Survey by Campbell & Clarkson  
Surveyors, Inc.

29222

APR 28 1977

1 5 8 5 APR 28 C

1.00 A4

S. C. R. L. S. No. 4678  
MICROFILMED

6D-2

*[Handwritten signature]*