

FILED
 GREENVILLE CO. S. C.
 NOV 14 4 56 PM '77
 DONNIE S. TANKERSLEY
 R.M.C.

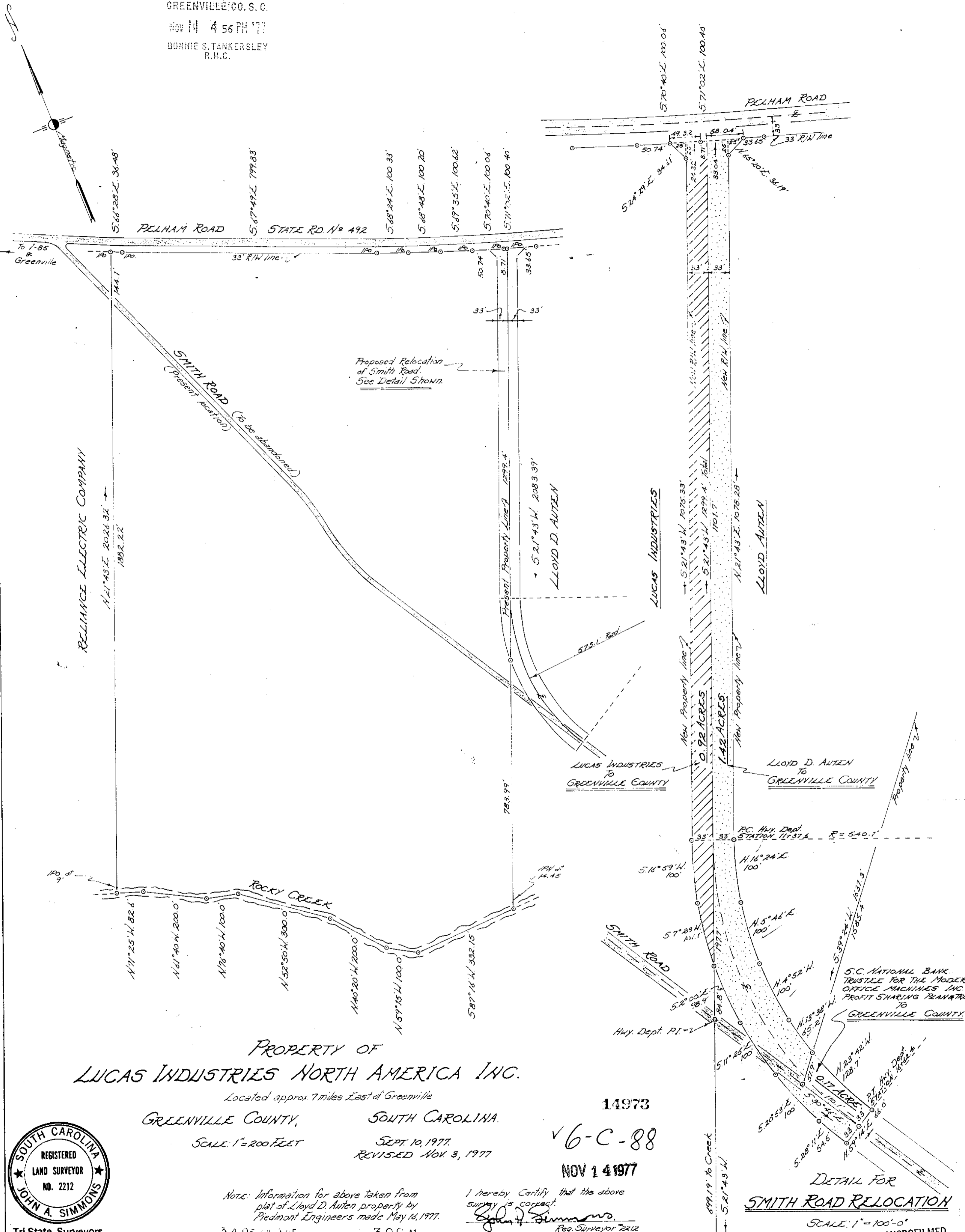

RELIANCE ELECTRIC COMPANY

N 21° 43' E 2026.32' ±
 1982.22

SMITH ROAD
 (Present Position)
 (To be abandoned)

Proposed Relocation
 of Smith Road
 See Detail Shown.

Present Property Line 1299.4
 S 21° 43' W 2083.39'
 LLOYD D. AUTEN

LUCAS INDUSTRIES

S 21° 43' W 1075.33'

LLOYD AUTEN

LLOYD D. AUTEN
 TO
 GREENVILLE COUNTY

LUCAS INDUSTRIES
 TO
 GREENVILLE COUNTY

PC HWY DEPT
 STATION 117+97.4 R = 540.1'

PROPERTY OF
 LUCAS INDUSTRIES NORTH AMERICA INC.

Located approx 7 miles East of Greenville

GREENVILLE COUNTY, SOUTH CAROLINA.

SCALE: 1" = 200 FEET

SEPT. 10, 1977
 REVISED NOV. 3, 1977

14973

✓ 6-C-88

NOV 14 1977



Tri-State Surveyors
 109 Few Street
 Greer, S. C. 29651

Note: Information for above taken from
 plat of Lloyd D. Auten property by
 Piedmont Engineers made May 16, 1977.

I hereby Certify that the above
 survey is correct.
 John A. Simmons
 Reg. Surveyor 2212

34 02 NOV 14 E 3.00 M

DETAIL FOR
 SMITH ROAD RELOCATION

SCALE: 1" = 100'-0"
 MICROFILMED