

MICROFILMED

NOTE: Improvements on this lot are not in a flood hazard area.

FILED  
GREENVILLE CO. S. C.  
Nov 12 4 36 PM '76  
DONNIE S. TANKERSLEY  
R.M.C.

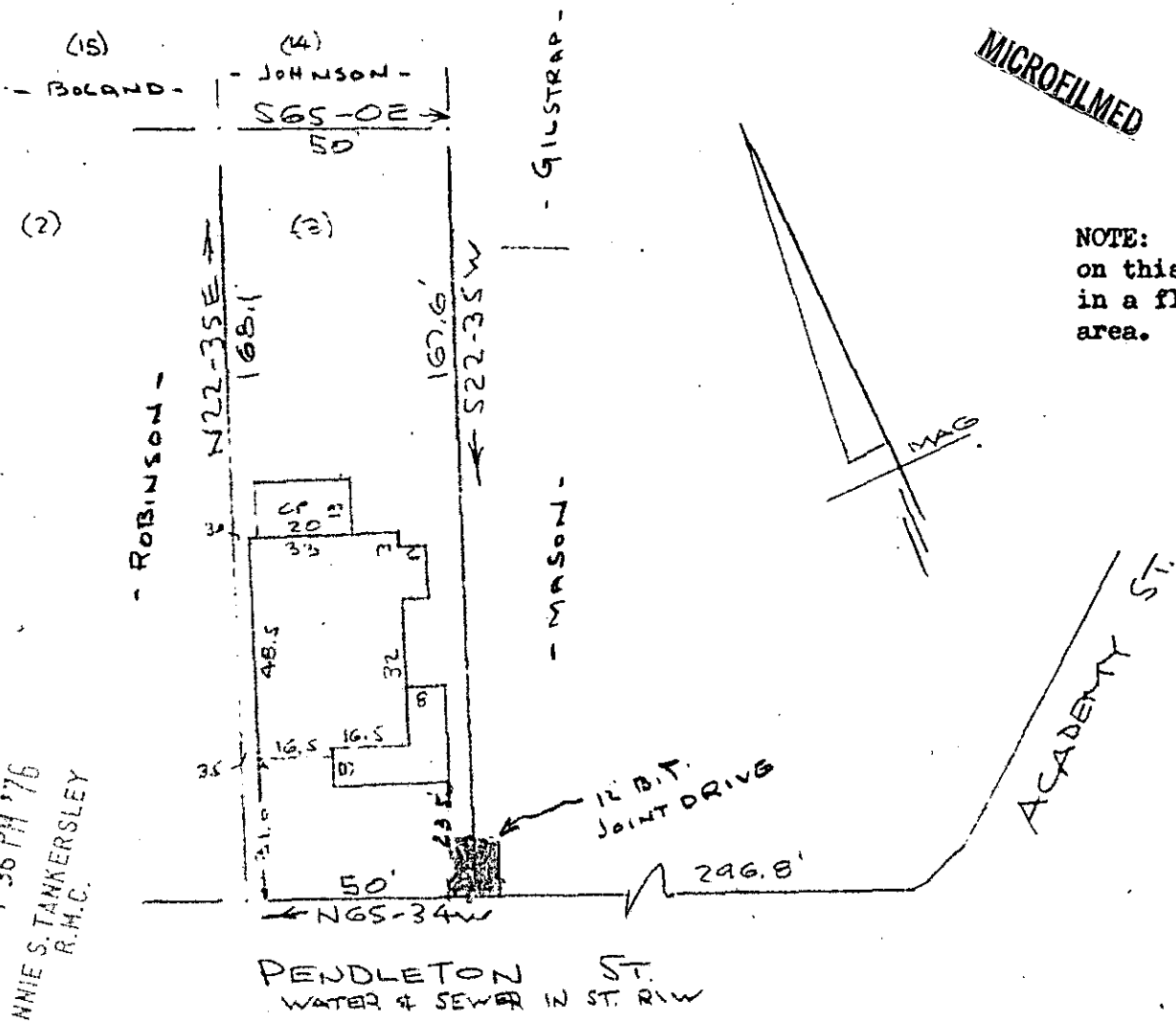

PENDLETON ST.  
WATER & SEWER IN ST. R/W

PROPERTY OF  
WOODROW J. COPELAND & SARAH S. COPELAND  
GREENVILLE, S. C.  
SCALE: 1" = 40'  
3 NOV 1976

This is to certify that on the 3rd day of November 1976, I surveyed the property, lot 3, shown on this plat, being known as PROPERTY OF WOODROW J. COPELAND & SARAH S. COPELAND and recorded in the RMC Office Greenville County, S. C., in Plat Book at Page ; and that the property lines, walls, and buildings are as shown hereon, and that the walls and buildings located on said lot do not encroach or project on adjacent street or property, and that no adjacent walls or buildings encroach or project on said premises, and no power lines cross this property except as shown hereon.

R. B. Bruce  
R. B. Bruce, RLS #1952

NOV 12 1976

CAROLINA SURVEYING CO.  
112 Manly St.  
Greenville, S. C.

✓ 5-W-90

13260

304 NOV 12 1976

1.00 A3

19018 77-1-3

11/16/76