

DARBY ROAD

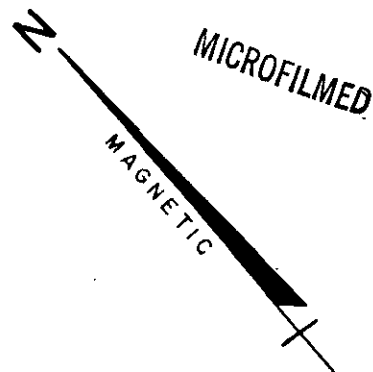
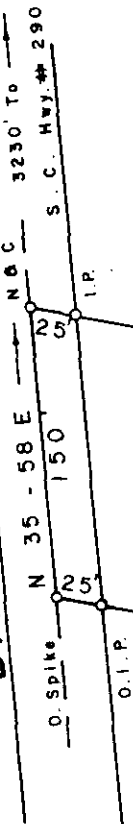

— OWENS —

S 38 - 27 E 455' 480' Tot.

1.6 AC.

N 38 - 27 W 455' 480' Tot.

— COLEMAN —

PROPERTY OF  
**RONALD W. BISHOP**  
**SELMA C. BISHOP**  
 ONEAL TOWNSHIP GREENVILLE CO.  
 SOUTH CAROLINA  
 APRIL 30, 1976

FILED  
 GREENVILLE CO. S.C.  
 JUN 3 11 41 AM '76  
 DONNIE S. TANKERSLEY  
 R.M.C.

31471

✓5-u-10

RECORDING FEE  
 PAID \$ 1.00

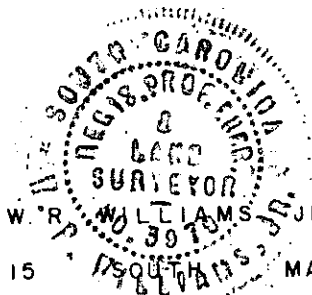

W. R. WILLIAMS, JR. ENGR. / SURVEYOR # 3979

15 SOUTHWEST MAIN STREET

TRAVELERS REST, S.C.

F.B.8

640.3 - 1 - PT.13

SCALE 1" = 100'