

FILED  
GREENVILLE CO. S. C.

JAN 9 11 13 AM '76

DONNIE S. TANKERSLEY  
R.M.C.

MICROFILMED

JAN 9 1976

← PT. LOT 70 -

- PT. LOT 71 -

N 48-22 E

60'

N 42-02 W  
173.5

- PT. LOT 71 -

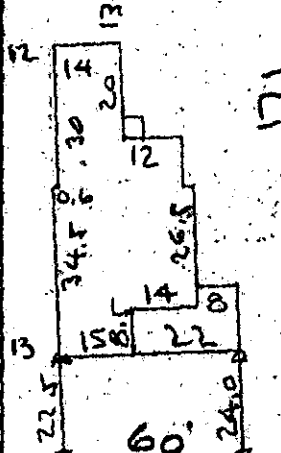
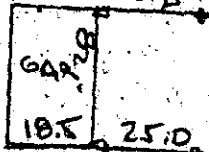

171  
S 42-02 E

S 46-03 W

Formerly  
(DOUGLASS AVE.)  
EVERGREEN AVE

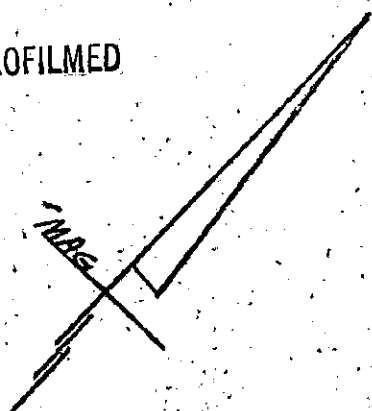

S. FRANKLIN ROAD  
WATER & SEWER IN ST. R/W

PROPERTY OF  
**THOMAS L. FLEURY**  
NEAR GREENVILLE, S.C.  
SCALE: 1" = 40' 21 JUNE 1972

This is to certify that on the 21st day of June 1972, I surveyed the property shown on this plat, being known as part of lot 71 on plat of PROPERTY OF COLONIA COMPANY ET AL and recorded in the RMC Office Greenville County, S.C., in Plat Book "G" at Page 112 and also being known as PROPERTY OF THOMAS L. FLEURY and recorded in the RMC Office in Plat Book 4U at Page 02 ; and that the property lines, walls and buildings are as shown hereon, and that the walls and buildings located on said lot do not encroach or project on adjacent street or property, and that no adjacent walls or buildings encroach or project on said premises, and no power lines cross this property except as shown hereon.

17546

59-31

RECORDING FEE  
PAID \$ 1.00

*R. B. Bruce*  
R. B. Bruce, RLS #195Z

CAROLINA SURVEYING COMPANY  
112 Manly St.  
Greenville, S. C.

100/34

829