

MICROFILMED

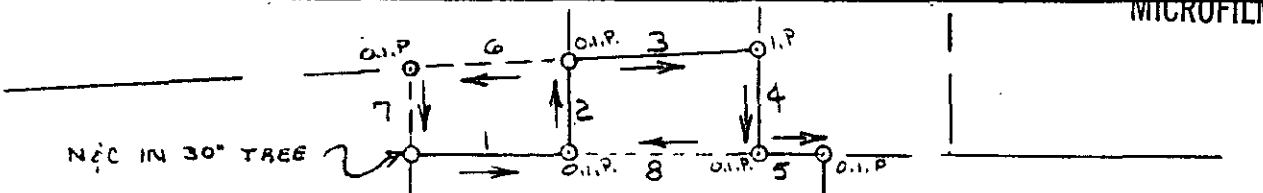

LOT 115

PART LOT 116

PART LOT 117

Side	Bearing	Distance
1	N25°-15'E	24.94'
2	N64°-45'W	14.6'
3	N22°-30'E	30.0'
4	S64°-45'E	16.05'
5	N25°-15'E	10.04'
6	S22°-30'W	25.1'
7	S64°-45'E	13.0'
8	S25°-15'W	30.0'

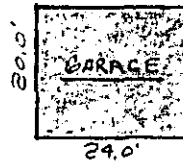

N 64° 45' W 151.0'

S 64° 45' E 151.0'

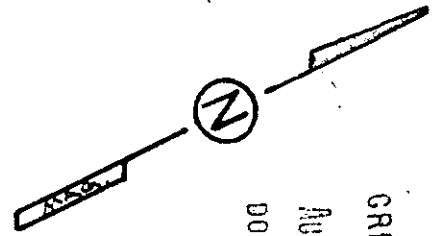
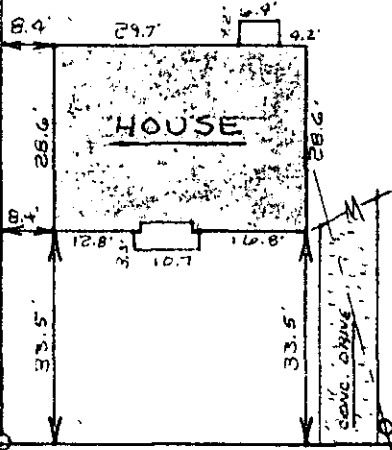

FILED
GREENVILLE CO. S.C.
AUG 6 2 56 PM '75
DONNIE S. TANKERSLEY
R.H.C.

WATER & SEWER IN ST. B/W
S 25° 15' W 65.0'
260' ± TO RODNEY ST.
RUTLEDGE AVENUE

This is to certify that on August 1, 1975, I surveyed the property shown on this plat, known as Part of Lot 116 on plat of the J.F. Rosemond Property, recorded in the R.M.C. Office of Greenville County in Plat Book H on Pages 186 & 187, and that the property lines, walls and buildings are as shown hereon; that the building located on said lot does not encroach or project on adjacent streets or property, and that no adjacent walls or buildings encroach or project on said premises, and that no utility lines cross this property except as shown hereon.

✓ 5M - 137

AUG 6 1975

James R. Freeland
James R. Freeland R.L.S. 4781

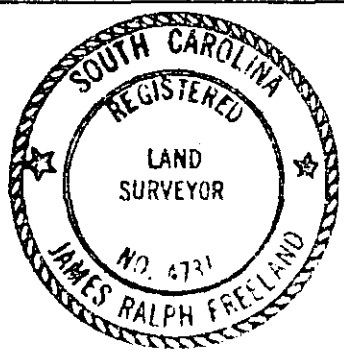

**STATE OF SOUTH CAROLINA
GREENVILLE COUNTY**

J.P. ROSEMOND PROP.
PART LOT 116
PROPERTY OF
DONAVAN VANCE CREWS
LOUISE R. CREWS

FREELAND & ASSOCIATES
Engineers • Land Surveyors

GREENVILLE, S. C.

SURVEY	FL BH
DRAWN	FL
CHECK	JF
SCALE	1" = 30'
DATE	8-1-75
DWG. NO.	75-591

RECORDING FEE
PAID \$ 07.00