

State of South Carolina
 County of Greenville
 Located 5.8 miles south west of
 the Ware Place.

Prepared July 16, 1975 at the request of
 Arthur Vaughn, Jr. and Shirley
 S. Vaughn.

The Boundary was copied from a
 plat of 6.868 acres, surveyed April 21, 1975
 by Hugh J. Martin, L.S. NO-2320, for
 Billy J. Chapman.

The 2 acre tract surveyed by me July 16,
 1975; This gives 4.868 acres remaining
 by deduction.

Alvin Freeman
 Alvin Freeman
 Registered Land Surveyor
 License #2991

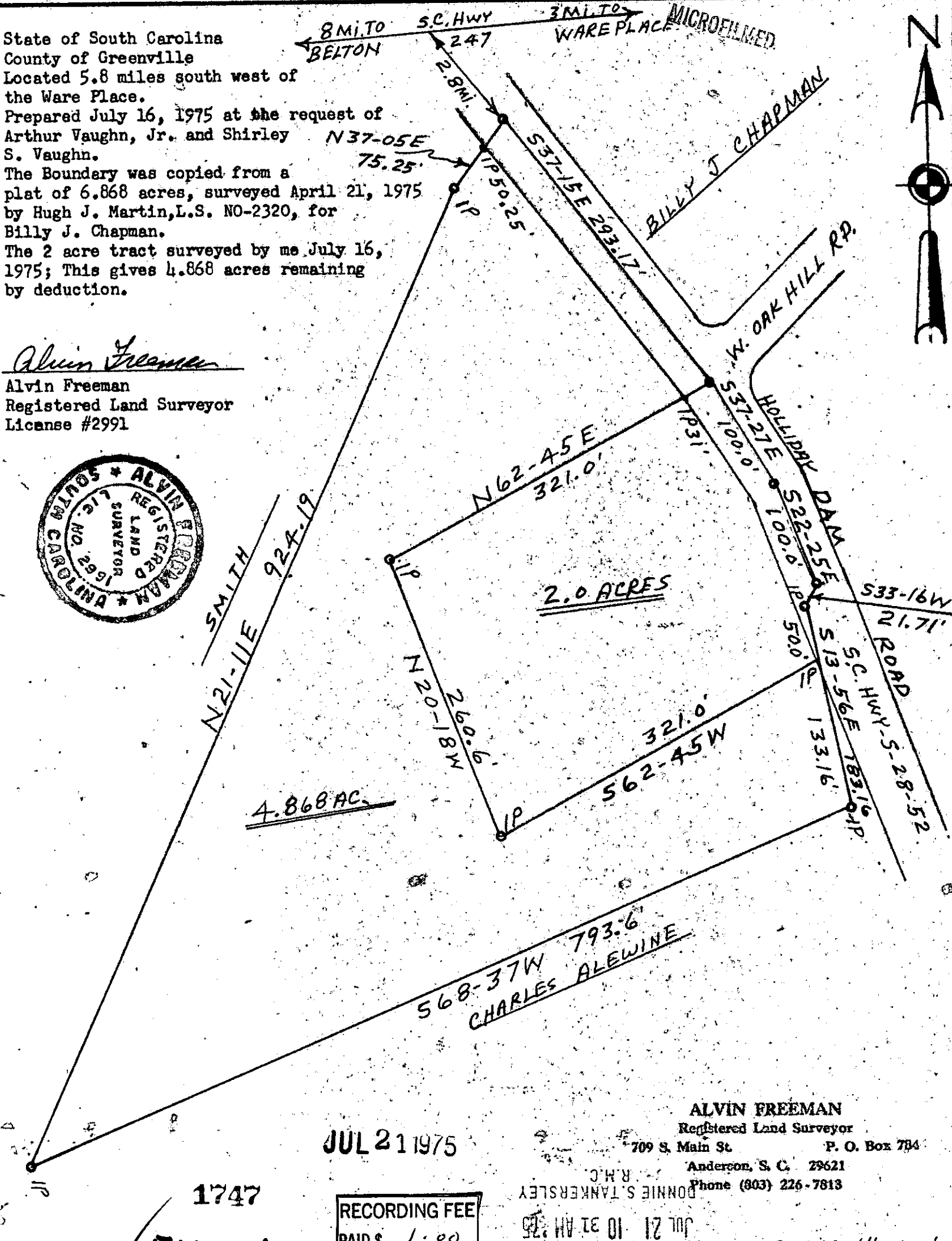

JUL 21 1975

ALVIN FREEMAN
 Registered Land Surveyor
 709 S. Main St. P. O. Box 784
 Anderson, S. C. 29621
 Phone (803) 226-7813

RECORDING FEE
 PAID \$ 1.00

DONNIE S. TANKERSLEY
 JUL 21 10 31 AM '75

SCALE 1" = 100'

✓ 5M-114

1747