

MICROFILMED

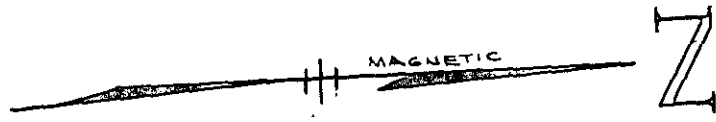

J.M. & LUCILLE P. COX

N85-10W
237.2 to 190. EDGE RD.

ELBERT BEASLEY

N0-22W 414.5

N85-10W 180

2.09 Acres

S85-10E
286.8 to 190.

S7-09 W 439.8 Rd.

ELBERT BEASLEY

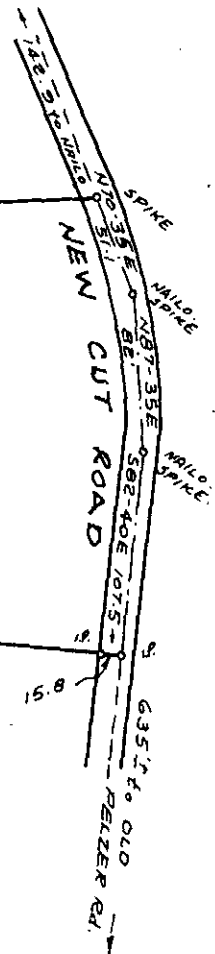

FILED
GREENVILLE CO. S. C.
JUL 14 8 48 AM '75
DONNIE S. TANKERSLEY
R.M.C.

MARIA W. KRUGOS

PROPERTY OF

JAMES E. BRAZEAL
AND
NANCY B. BRAZEAL
GREENVILLE, CO. S. C.

JUL 14 1975

RECORDING FEE
PAID \$ 1.00

SCALE 1"=100'

JULY, 1975

5M-109

1075

