

MICROFILMED

RECORDING FEE PAID \$ 200

J. W. BRANDT & L. E. DOYNER

MRS. LOTTIE KELLETT

MITCHEL KATE

RALPH T. & TRYSSA C. KELLETT

312.0 PARKINS MILLER

N 66-50-30 E 708.6

"A" 4.05 Ac.

483.35 262.45

N 21-50-30 W 220.9

S 64-10 W 725.7

230.0

635.5

"B" 6.412 Ac.

N 22-35 W 131.15

37.0 37.0

37.0 R/W

LAURENS ROAD

405.5 525-44 E

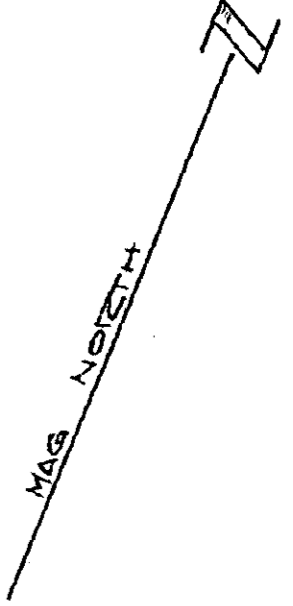

DUKE POWER CO.

I.P.O.

S 68-24 W 749.85

37.0 R/W

WALTER S. GRIFFIN ETAL.

R/W

10885

GREENVILLE CO. S.C. FILED  
OCT 19 9 43 AM '73  
DONNIE S. TANKERSLEY R.M.C.

OCT 19 1973

5B-31

ROBERT R. SPEARMAN  
Registered Surveyor 3615

Post Office Box 6  
Easley, South Carolina 29640



TITLE PROPERTY OF  
MALCOLM L. BEUHLEZ

STATE S.C. COUNTY GREENVILLE

SCALE 1"=100' DATE JUNE 20, 1973 REF. NO.